



15 Jack Mcnamee Place Kellyville NSW

4 3 2

Positioned in the Duncraig Estate, this quiet and sought-after neighbourhood is within easy reach of major shopping centres, excellent schools and a choice of Metro Stations.

Type : House

View : <https://www.gilmour.com.au/lease/nsw/hills/kellyville/residential/house/8161171>

Features of this masterpiece include:

- Beautifully manicured front garden
- Undercover front porch leading into the grand foyer entrance
- Open plan, formal living and dining area
- Spacious casual dining area off the kitchen
- Additional sun-drenched family living area flowing out to the backyard
- Stylish, modern kitchen equipped with large island



Gilmour Property Agents
02 9899 3311

[For full version visit the website](https://www.gilmour.com.au)

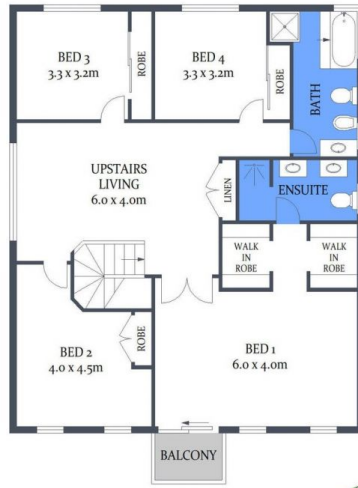

15 Jack McNamee Place, Kellyville

Scale shown in meters. All dimensions herein are approximate and gathered from sources believed to be reliable. Whilst every effort is made for the accuracy of our floor plans, interested parties should rely on their own enquiries.



Land Area 626sqm