



30 George Mobbs Drive Castle Hill NSW

4  2  2 

? Built in 1974 by the current owners, and impeccably maintained ever since, this much-loved Habitat home is offered to the market for the very first time.

? Located in the sought-after East Excelsior Precinct of Castle Hill in an award-winning, tree-lined drive, this family home is set on a large 675.8 sqm garden block with an impressive 18.3-metre frontage (approx.) midway between the Olive Grove shops at Baulkham Hills and Castle Towers Shopping Centre and the Metro train station.

? Sitting high proud & handsome this stunning contemporary style family home features easily maintained mature gardens and lawns and a perfect north aspect to the back, flooding it with warmth & natural light.

? Ahead of its time, the home is filled with European fittings and accessories and incorporates a unique commercial grade sky roof that floods the casual living with light.

? The large formal lounge room flows to the dining room

Land Size : 695 sqm

View : <https://www.gilmour.com.au/sale/nsw/hills/castle-hill/residential/house/7670067>



Craig Alexis
02 9899 3311

30 George Mobbs Drive, Castle Hill

Please note:
Floorplan measurements are a guide only.
All dimensions are approximate in their distance and volume.

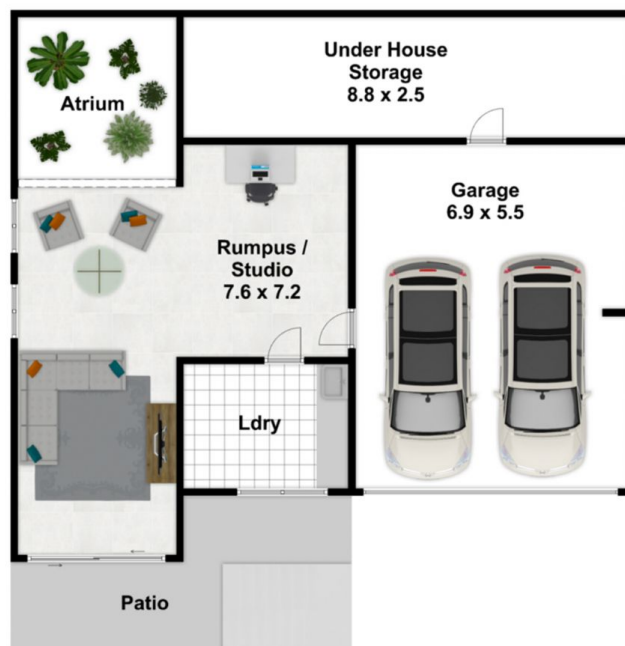

-  4
-  2
-  2