



**11 Peppertree Place Castle Hill NSW**

4 2 4

Located in a culdesac amongst other modern quality residences close to the Showground Metro Train station, Kellyville Primary School , St Angela's Primary School , William Clarke College and the Kellyville Plaza shops.

This awesome 4 bedroom + study family home sits on an easy to maintain 450m2 block & has oodles of living space

All 4 bedrooms have built in wardrobes except the master which has a walk in robe and an ensuite.

The lounge & separate dining rooms have lovely timber flooring and are close to the Polyurethane kitchen with loads of storage cupboards, a gas cook top, ducted range hood and there is plenty of preparation space.

[For full version visit the website](#)

**Type** : House  
**Price** : \$ 1,950,500  
**Land Size** : 450 sqm  
**View** : <https://www.gilmour.com.au/sale/nsw/hills/castle-hill/residential/house/7631193>



**Craig Alexis**  
02 9899 3311

# 11 Peppertree Place, Castle Hill

Please note:  
Floorplan measurements are a guide only.  
All dimensions are approximate in their distance and volume.  
Structures are not in position on the floorplan.

Rear

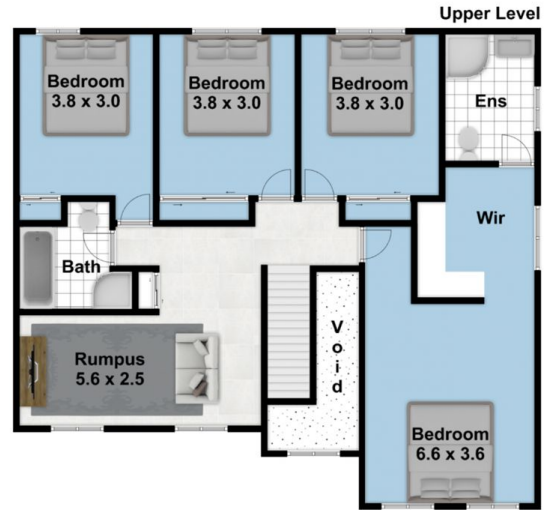
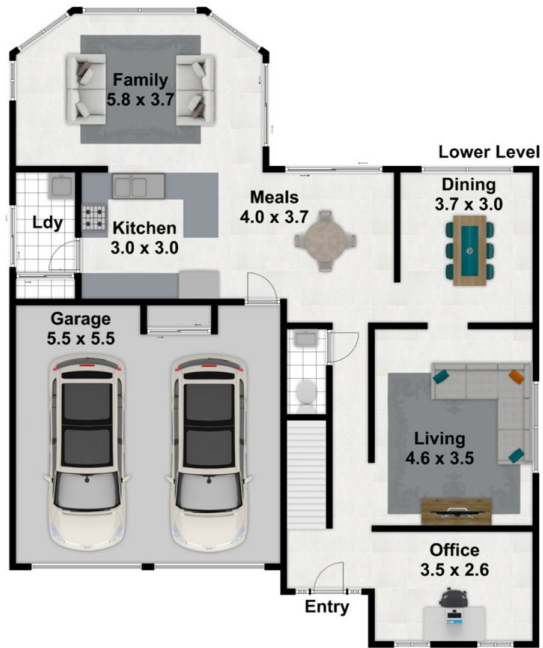

Front

-  4
-  2
-  2