



**9 Crego Road Glenhaven NSW**

4 2 2

Located in the sought after Sandhurst Estate and in good company surrounded by other Masterbuilt quality family homes, in a quiet culdesac.

Close to the Glenhaven and Samuel Gilbert Public Primary Schools, William Clarke and Oakhill Colleges and the shops at Round Corner Dural and Castle Towers.

A perfect sunny north aspect to the front floods this stunning Architect designed family home with natural light & warmth and the sandstone features with the sandstock bricks makes it very pleasing to the eye.

In through the entrance and you are greeted with the formal areas, warmed by a cosy fire place and french doors open

**Type** : House  
**Land Size** : 730 sqm  
**View** : <https://www.gilmour.com.au/sale/nsw/hills/glenhaven/residential/house/7621898>



**Craig Alexis**  
02 9899 3311

[For full version visit the website](#)

# 9 Crego Road, Glenhaven

Please note:  
Floorplan measurements are a guide only.  
All dimensions are approximate in their distance and volume.

## Upper Level

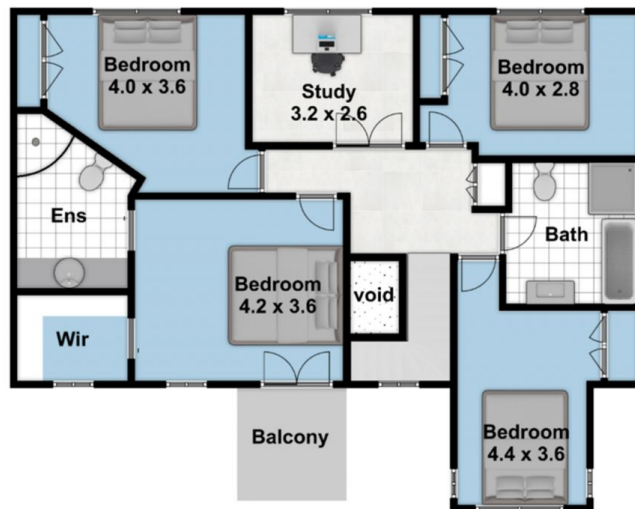

## Middle Level

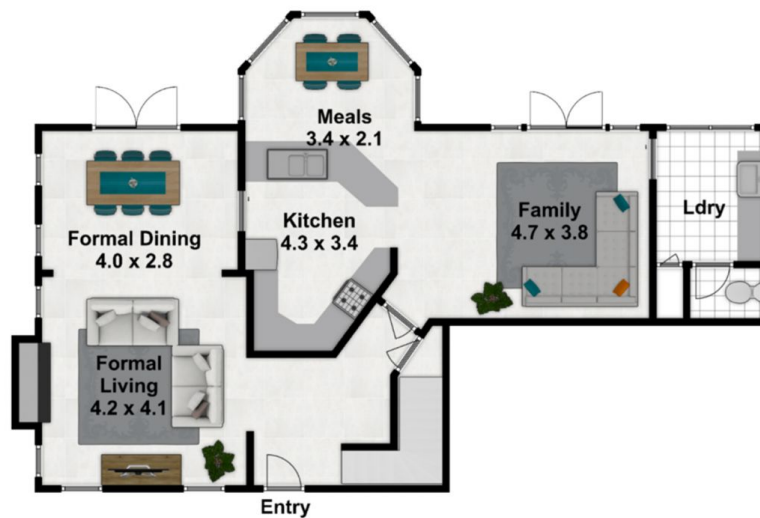

## Lower Level

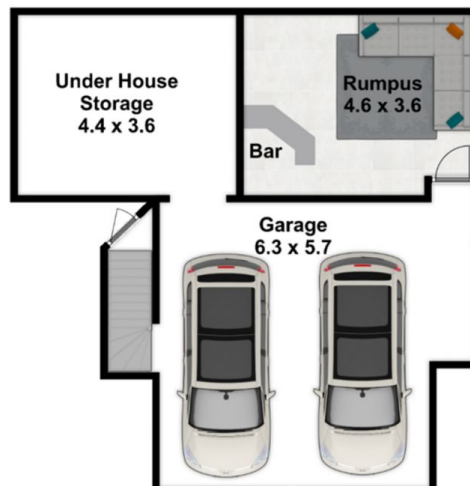

-  4
-  2
-  2