



594 Victoria Road Ermington NSW

3 2 2

PLEASE PARK ON WENTWORTH STREET TO INSPECT

This much-loved family home offers an ultra-convenient location as well as ample space for both indoor and outdoor living. Solid brick construction that offers three-bedrooms, two bathrooms and multiple living areas as well as a detached double garage with private rear lane access.

With city buses at your doorstep and only moments away from train stations and ferry wharfs, the location of this home will appeal to a wide range of buyers seeking a convenient, low maintenance lifestyle that is close to all amenities.

Type : House
Price : \$ 1,400,000
Land Size : 467 sqm
View : <https://www.gilmour.com.au/sale/nsw/parra-matta/ermington/residential/house/7575175>



Noah Khanjani
02 9899 3311

[For full version visit the website](https://www.gilmour.com.au)

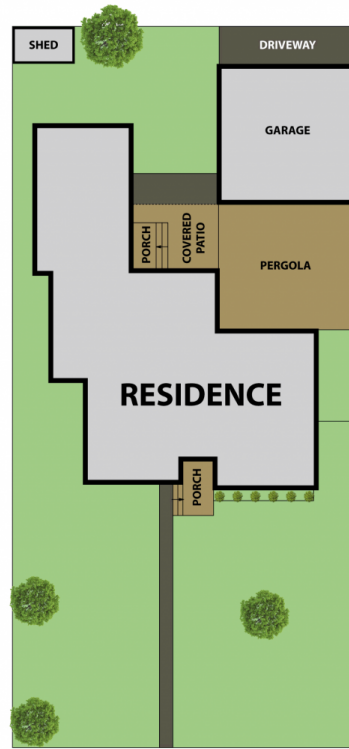

594 VICTORIA RD, ERMINGTON

DISCLAIMER:

All information contained herein is gathered from sources we consider reliable. However, we cannot guarantee or give away any warranty to the information provided.

