



## 1 Cypress Road North St Marys NSW

4  2  2 

Centrally located in the heart of North St Marys, this newly renovated, freshly painted home is close to all amenities. Minutes away from shopping districts, a short stroll to schools, public transport, and approximately 2km to St Marys Train Station, which is also a soon to be metro for the new upcoming Western Sydney Airport.

**View :** <https://www.gilmour.com.au/lease/nsw/western-sydney/north-st-marys/residential/house/6645148>

It includes:

- new flooring
- reverse cycle air conditioning
- carport for 2 cars
- 2 brand new bathrooms
- brand new kitchen and appliances
- built in robes
- garden shed
- ceiling fans to all bedrooms



**Gilmour Property Agents**  
**02 9899 3311**

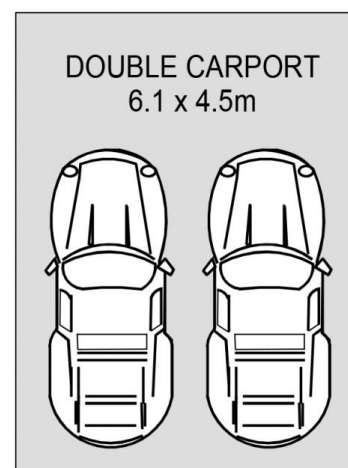
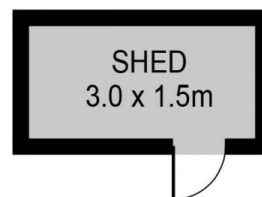
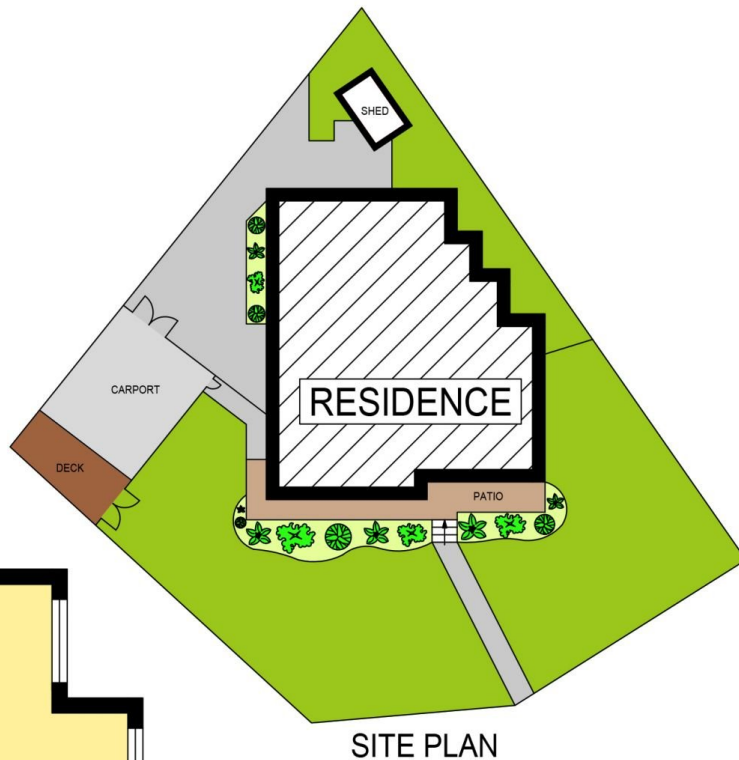

## 1 CYPRESS ROAD, NORTH ST MARYS

### DISCLAIMER:

PLANS SHOWN ARE FOR MARKETING PURPOSES ONLY, ALL DIMENSIONS ARE APPROXIMATE AND NOT TO SCALE. THEY ARE SUBJECT TO ERRORS AND INACCURACIES AND NO LIABILITY WILL BE ACCEPTED. INTERESTED PARTIES SHOULD MAKE THEIR OWN INQUIRIES.

RayWhite