



35 St Pauls Avenue Castle Hill NSW

4  2  3 

Located in a premier house proud avenue surrounded by other quality residences close to St Angela's Primary School, William Clark College and the local Kellyville Plaza shopping centre.

Land Size : 624 sqm
View : <https://www.gilmour.com.au/sale/nsw/hills/castle-hill/residential/house/6437934>

This substantial brick & tile 2 storey family home on a level 624m² block with a perfect sunny north aspect to the back yard has so much to offer.

4 generous size bedrooms all with built in wardrobes & the master bedroom has an ensuite.

There is a study close to the entrance, handy for working from home and there is a formal lounge & dining area. In addition there is a casual meals , a family relaxing area, a separate rumpus room and a 2nd Rumpus room upstairs.

The gourmet gas kitchen has a 900mm gas stove which



Craig Alexis
02 9899 3311

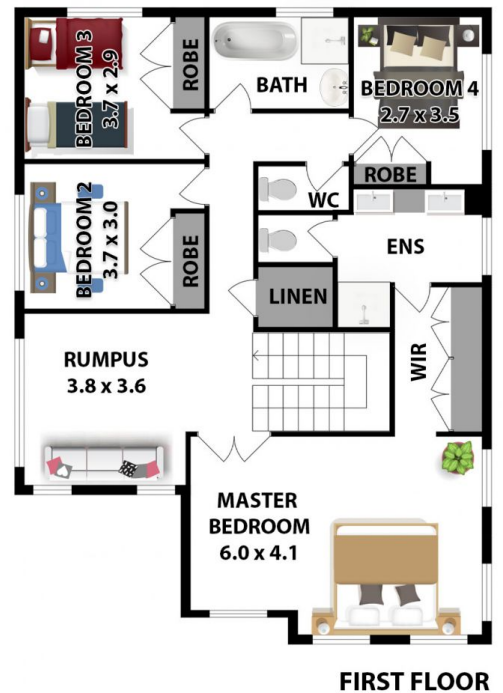
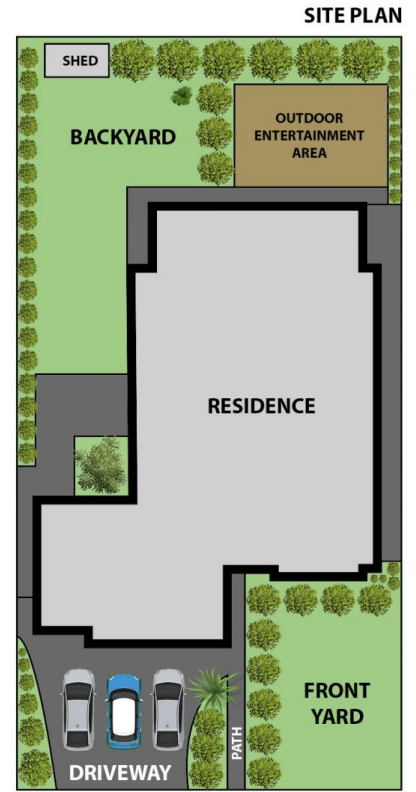
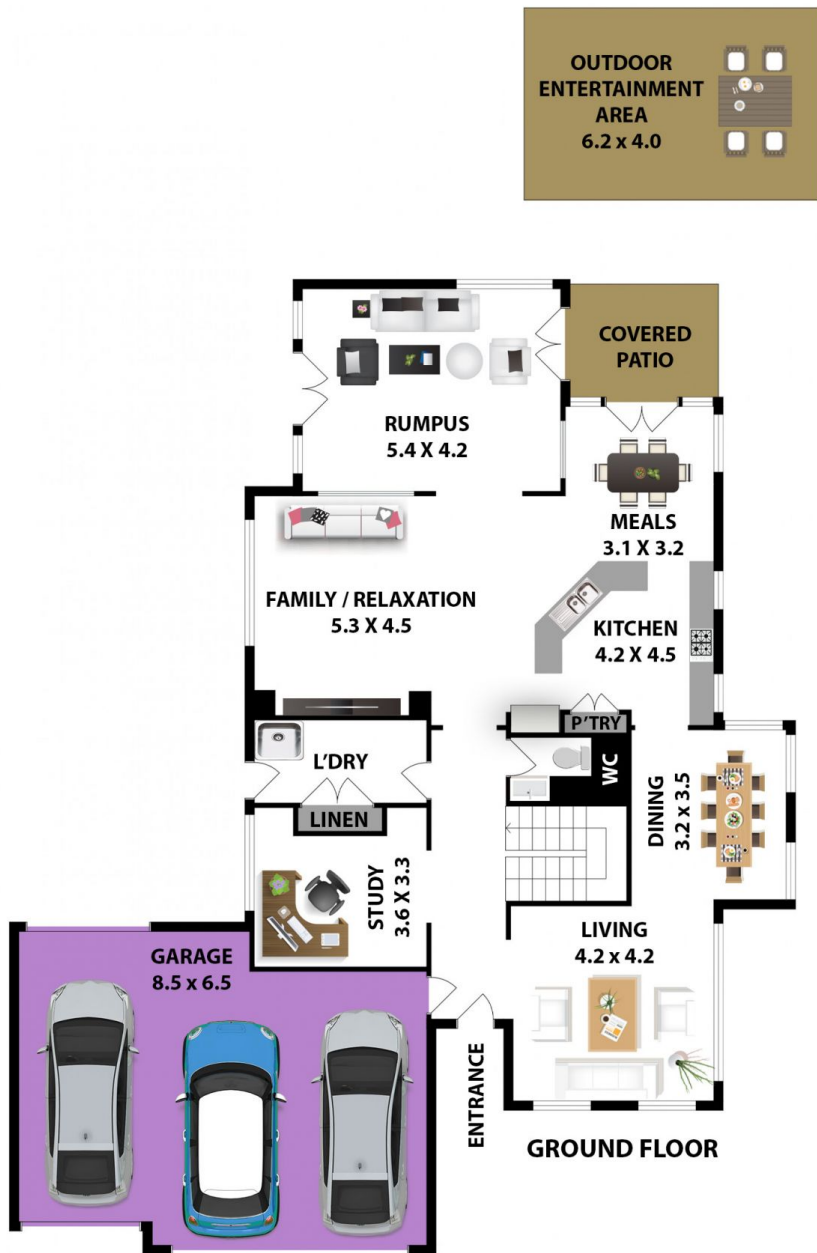

35 St Pauls Ave, Castle Hill

DISCLAIMER:

All information contained herein is gathered from sources we consider reliable. However, we cannot guarantee or give away any warranty to the information provided.

