



14/2 Rifle Range Road Northmead NSW

3 2 2

Located conveniently close to public transport at the front of the complex, easy access to the M2 for the city commute or escaping to the Blue Mountains for the weekend.

Price : \$ 835,000

View : <https://www.gilmour.com.au/sale/nsw/parramatta/northmead/residential/townhouse/5620824>

Close to the local primary school and Stockland Mall shopping Centre. This lovely, quiet and private townhouse, in a secure complex, has three bedrooms, two of which have built-in wardrobes, the master bedroom has an ensuite and there is a study nook too.

A separate living room and dining room have new floating timber floors (not shown in the current photos) and the functional Granite & Polyurethane kitchen has plenty of preparation area to create your culinary masterpieces.

The back cedar French doors lead you to a low maintenance, paved courtyard ideal for entertaining family



Craig Alexis
02 9899 3311

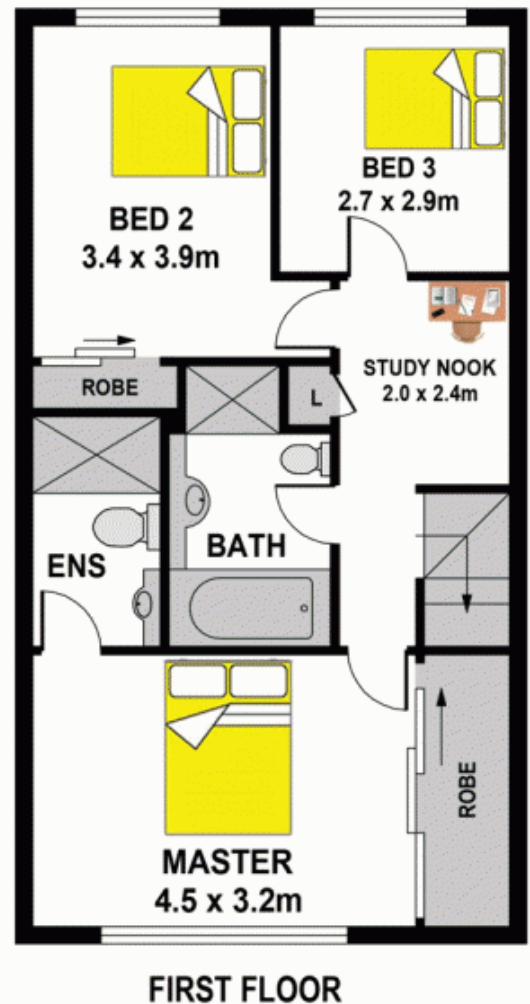
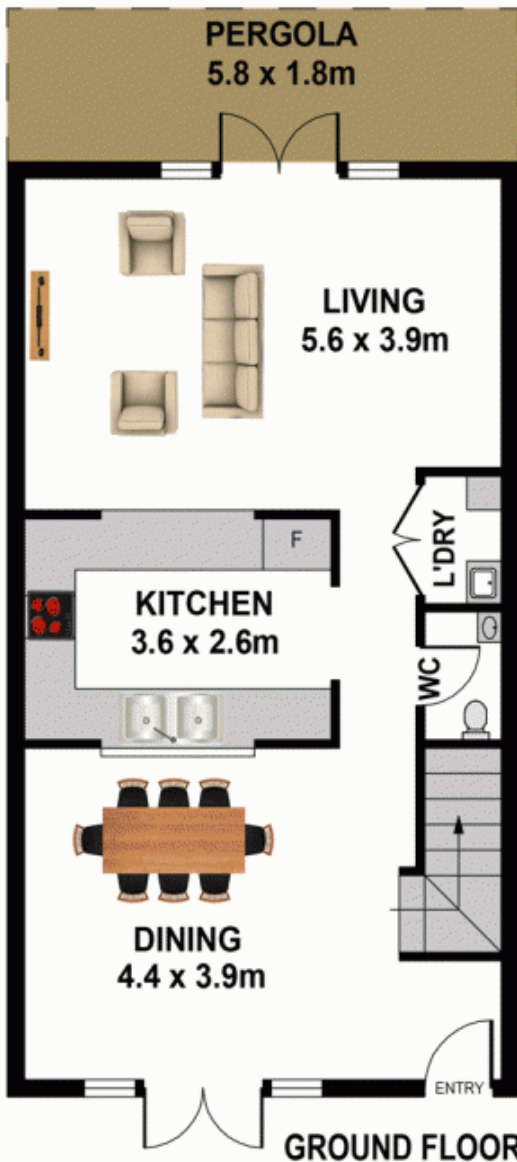
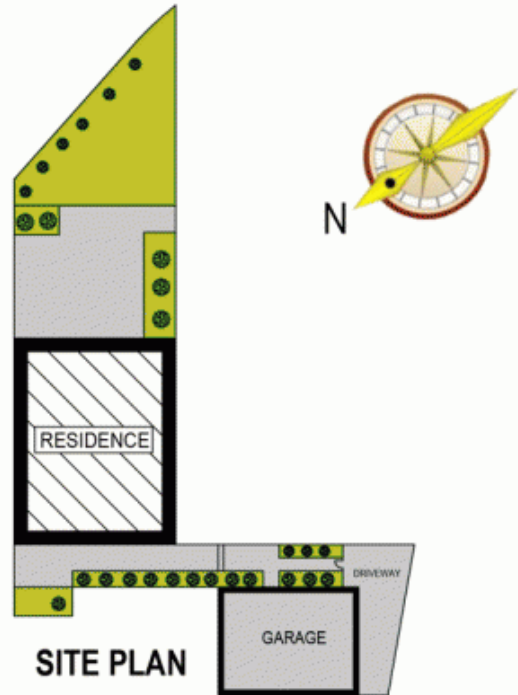
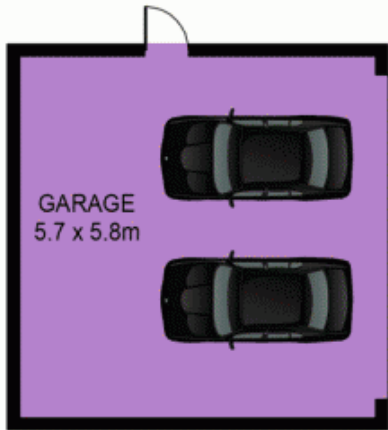

14/2 RIFLE RANGE ROAD, NORTHMEAD

DISCLAIMER:

All information contained herein is gathered from sources we consider to be reliable however we cannot guarantee or give any warranty to the information provided.

