



## 5 Whitling Avenue CASTLE HILL NSW

4 2 2

Proud to offer this beautifully kept, 696m<sup>2</sup> single level home to the market. R3 zoned and on a flat level block with an attractive facade and only minutes from Castle Towers Shopping Centre. This tidy home is perfect for the first home buyer, young family or an astute investor. Upon entry you will find:

- Four good sized, carpeted bedrooms, all with built in robes, the master has an ensuite and walk in robe.
- Open plan kitchen flows onto the informal dining and family area. Also offering light and bright formal lounge and dining area.
- Spacious, low maintenance backyard with concreted alfresco plus grassed area, convenient side access and a shed for storage.
- Additional features include a study, security alarm, split

**Type** : House  
**Land Size** : 696 sqm  
**View** : <https://www.gilmour.com.au/sale/nsw/hills/castle-hill/residential/house/5620821>



**Gilmour Property Agents**  
**02 9899 3311**

[For full version visit the website](https://www.gilmour.com.au)



**SITE PLAN**

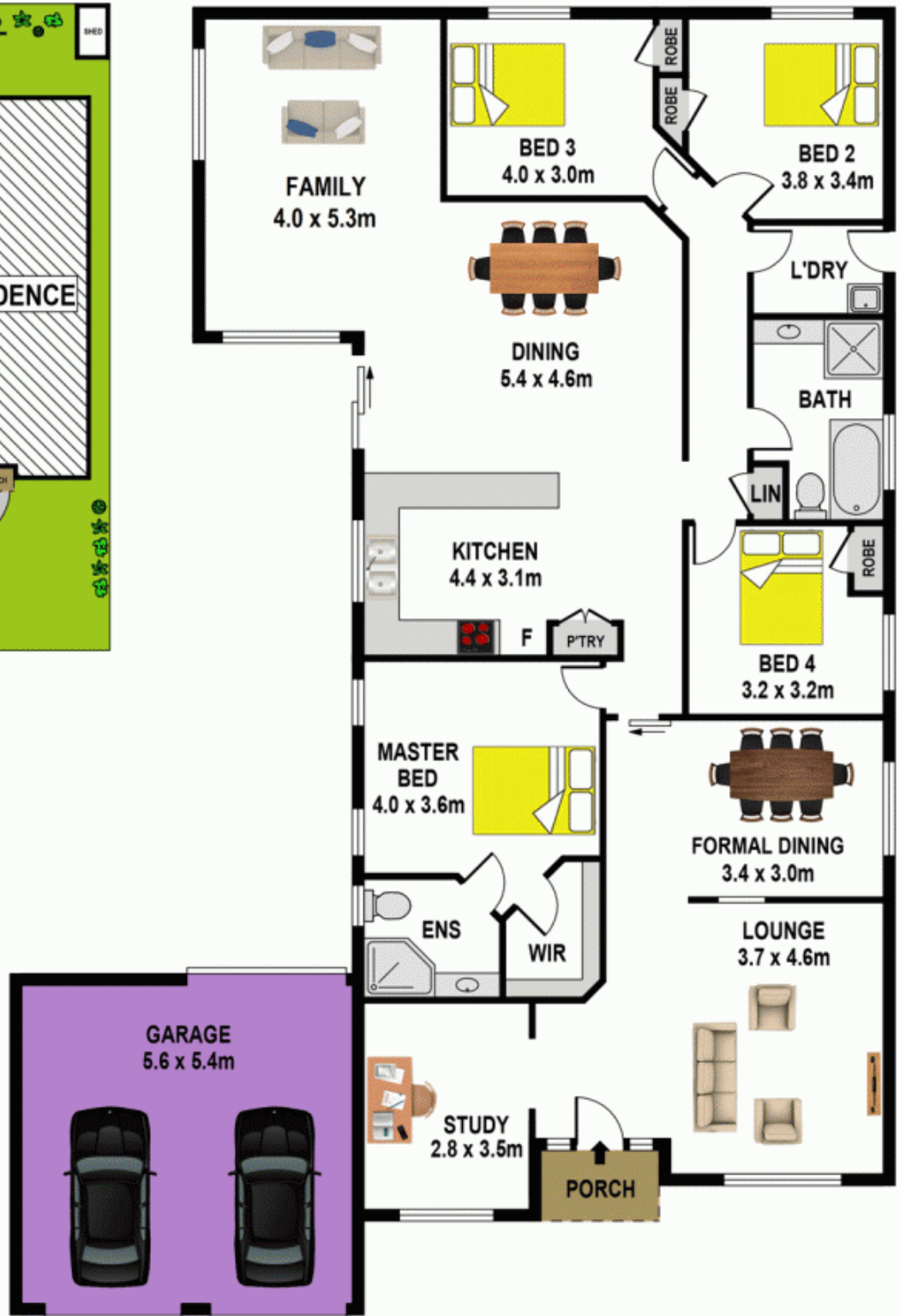

## 5 WHITLING AVENUE, CASTLE HILL

**DISCLAIMER:**

All information contained herein is gathered from sources we consider to be reliable however we cannot guarantee or give any warranty to the information provided.