

102/23-35 Crane Road Castle Hill NSW

2 2 2

Whether you're looking to invest or wanting modern living in the heart of Castle Hill, this fantastic top floor apartment with 180 degree views from Parramatta through to the Blue Mountains, will be perfect for you!

- Conveniently situated in a private security complex the apartment is only a short stroll to Castle Towers shopping complex, bus interchange and within 400m of the future North West Rail Link.
- The gourmet kitchen is complete with quality stainless steel appliances, gas cooktop as well as plenty of storage and bench space.
- The master bedroom features built-in robe with modern ensuite while the other bedroom boasts sliding doors onto the second balcony.
- Entertaining is effortless as the open plan lounge and

**Type** : Apartment

**View** : <https://www.gilmour.com.au/sale/nsw/hills/castle-hill/residential/apartment/5620780>



**Brendan Dabaja**  
02 9899 3311

[For full version visit the website](#)

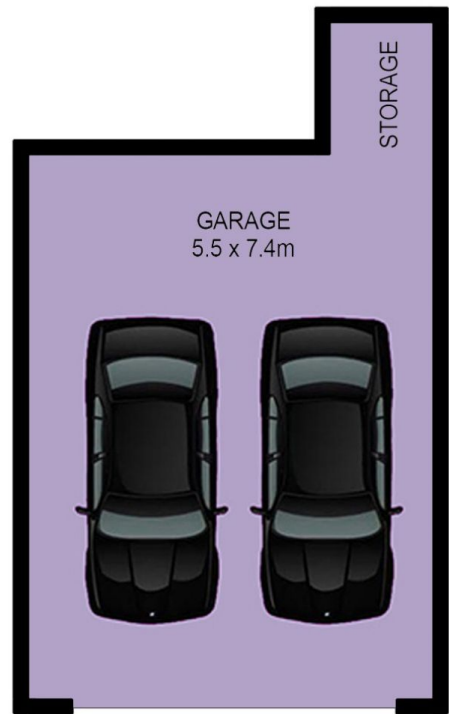
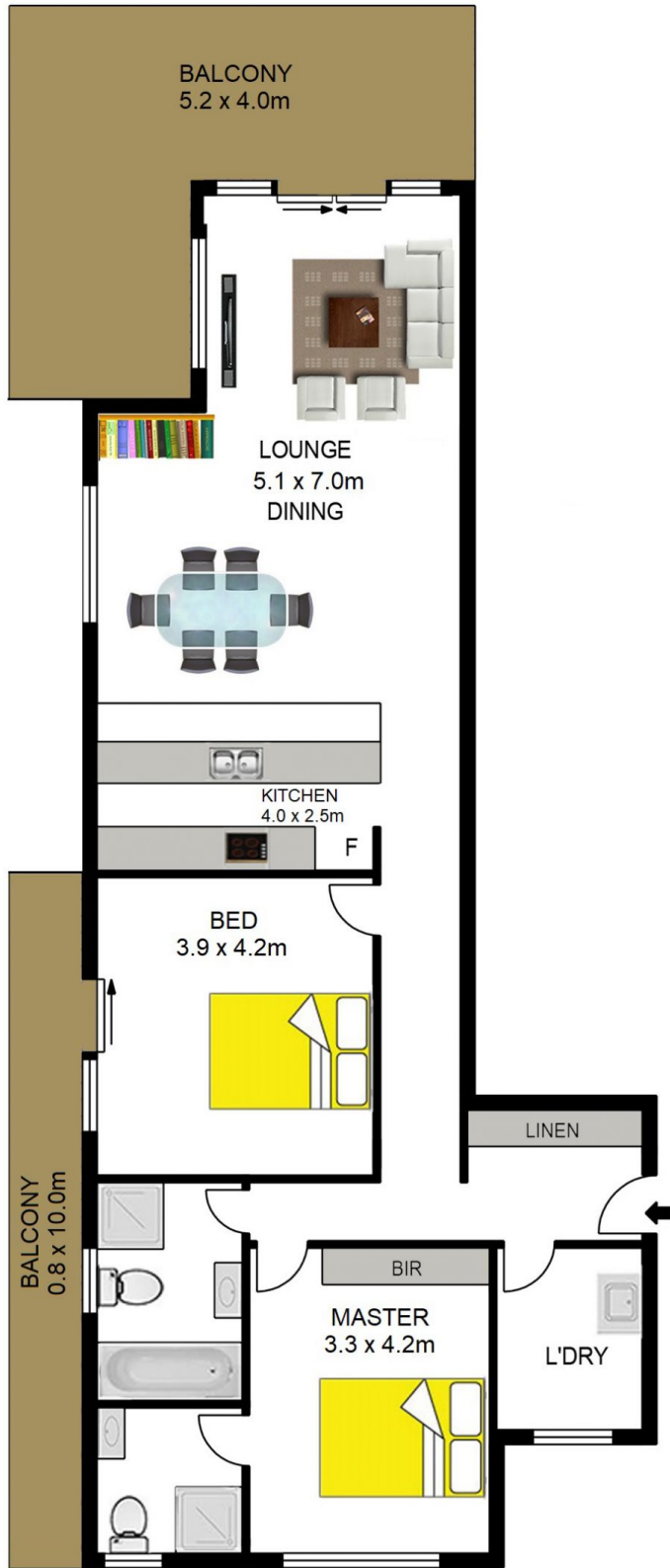

## 102/23-25 CRANE ROAD, CASTLE HILL

**DISCLAIMER**

All information contained herein is gathered from sources we consider to be reliable, however we cannot guarantee or give any warranty to the information provided.

