





6 Cedar Grove CASTLE HILL NSW

5  3  4 

Situated in a quiet, friendly culdesac surrounded by house proud neighbours is this stunning family home in a fantastic location with easy access to Fred Caterson reserve and the future Showground train station. This Arthur Billiard masterpiece has all the luxurious features you need for executive style living in the heart of Castle Hill.

- Five double sized bedrooms, four with built-in robes and the master suite also offers an additional walk-in wardrobe and an ensuite

- There is a wealth of formal and informal living areas including a separate lounge & dining room, rumpus and a meals/family room which adjoins the beautifully finished granite kitchen which boasts an enormous amount of preparation and bench space
- The huge rear pergola is perfect for entertaining and

Type : House
Land Size : 709.3 sqm
View : <https://www.gilmour.com.au/sale/nsw/hills/castle-hill/residential/house/5620582>



Gilmour Property Agents
02 9899 3311

[For full version visit the website](https://www.gilmour.com.au)

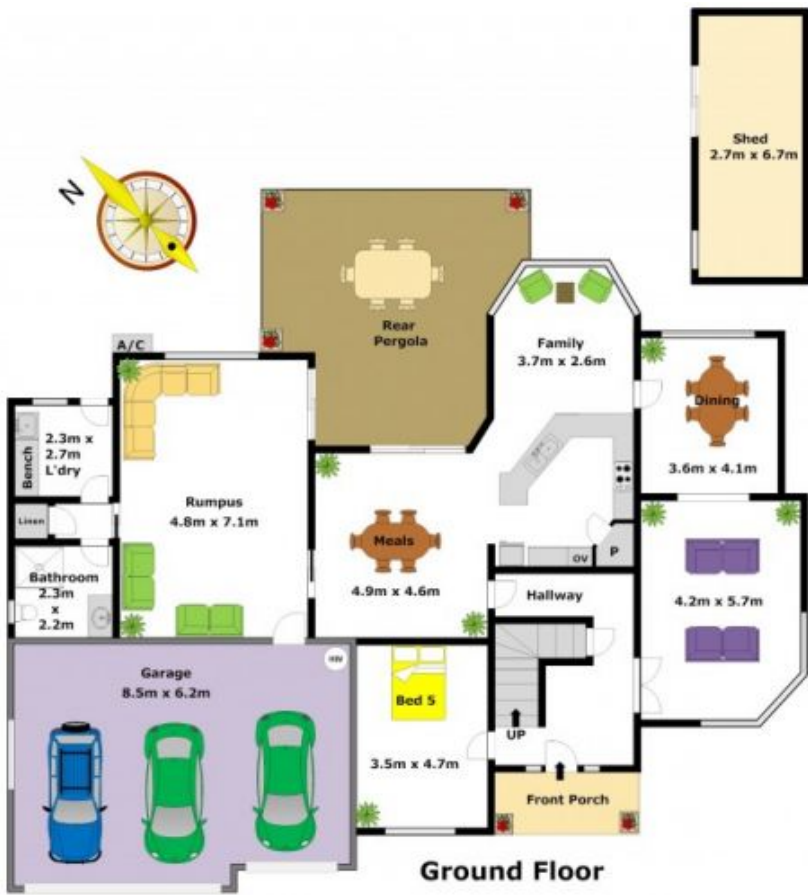

DISCLAIMER:
 While every attempt has been made to ensure the accuracy of the floor plan contained herein, no responsibility is taken for any errors, omissions, or misstatements. This floor plan is intended as a guide only. The representation contained herein should be used in conjunction with any prospective purchaser. Its preparation or correction can be given, and any person using this information is deemed to do so at their own risk.

