





## 83 Yaringa Road CASTLE HILL NSW

5  3  3 

Sitting proud & handsome in the popular Balintore Estate is this fantastic family home on a 702sqm block that boasts a tranquil bush backdrop. This substantial Masterbuilt residence was originally crafted in 1996 by Denton Homes, this is a fantastic opportunity offering substance, location, style and quality in one. Featuring five generous bedrooms and three bathrooms including two en-suites one of which adjoins the downstairs fifth bedroom providing a suitable setting for in-law accommodation or a home office. The polished floorboards throughout will perfectly compliment your furnishings and they also further enhance the high 9.5 foot ceilings in the huge formal lounge & dining room. Whilst the open plan kitchen which flows out to a meals & family area lets soul of the house shine through and takes in the lovely bush outlook plus there is a large separate

**Type** : House  
**Price** : \$ 1,150,000  
**Land Size** : 702.3 sqm  
**View** : <https://www.gilmour.com.au/sale/nsw/hills/castle-hill/residential/house/5620457>



**Gilmour Property Agents**  
**02 9899 3311**

[For full version visit the website](https://www.gilmour.com.au)

**Ground Level**

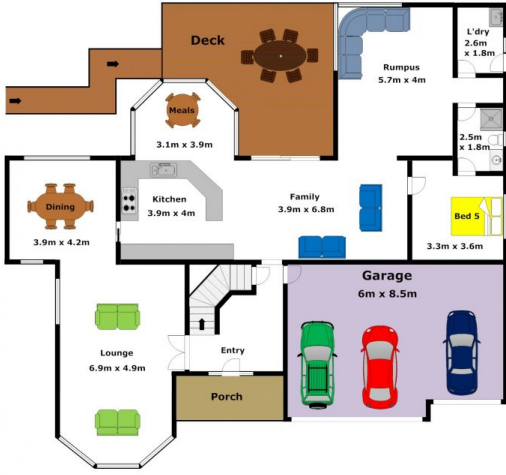

**Upper Level**

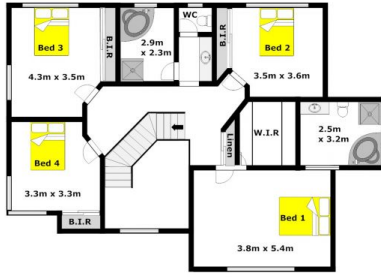

**Sub Level**

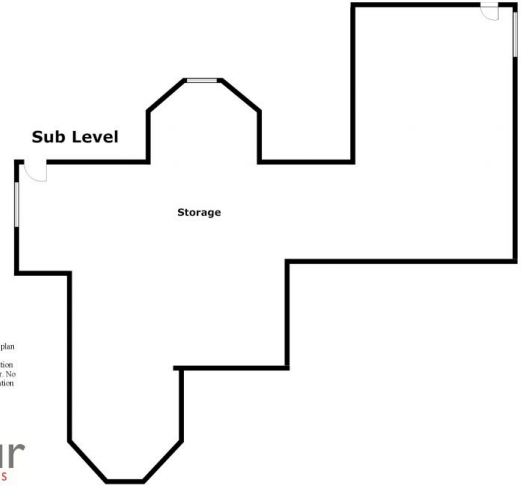

DISCLAIMER:  
Whilst every attempt has been made to ensure the accuracy of the floor plan contained here, no responsibility is taken for any error, omission, or misstatement. This floor plan is intended as a guide only, for representation purposes only, and should be used as such by any prospective purchaser. No guarantee or warranties can be given, and any person using this information should rely on their own enquiries.

