



4 Christine Court KELLYVILLE NSW

4  2  2 

Sophisticated & substantial is this 45 square executive residence enviably positioned in a whisper quiet cul-de-sac within convenient access to all essential amenities. Set on 670sqm, this dual level home boasts four large bedrooms plus a separate study all with built-ins or walk-in robes and there are 2.5 contemporary bathrooms including the en-suite to the master retreat. Flooded with natural light which compliments the wealth of living space comprising of an oversized formal lounge & dining room, an upstairs games room/teenagers retreat, a separate TV/rumpus room and a private billiards room at the rear that could easily be utilized as a home theatre. The heart of the home is the tiled family room and the adjoining generously proportioned, new chefs kitchen with 40mm stone bench tops, gas cooking and stainless steel appliances. Continue

Type : House
Building Size : 45 sqm
Land Size : 670.3 sqm
View : <https://www.gilmour.com.au/sale/nsw/hills/kellyville/residential/house/5620436>



Gilmour Property Agents
02 9899 3311

[For full version visit the website](https://www.gilmour.com.au)

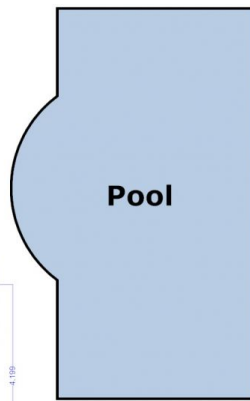
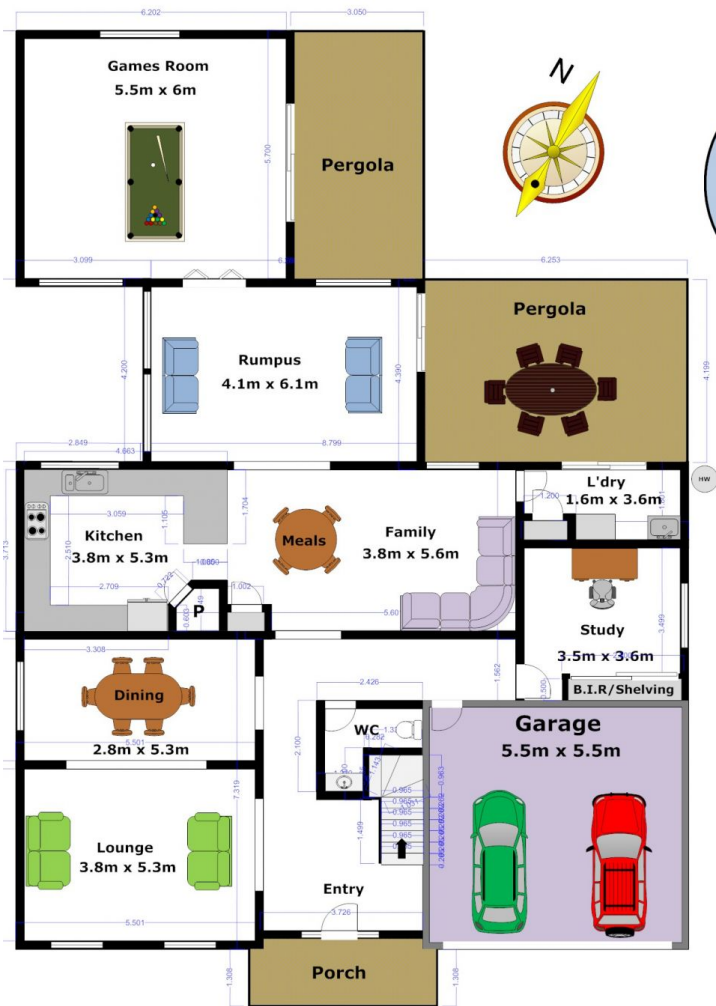

DISCLAIMER:

Whilst every attempt has been made to ensure the accuracy of the floor plan contained here, no responsibility is taken for any error, omission, or misstatement. This floor plan is intended as a guide only, for representation purposes only, and should be used as such by any prospective purchaser. No guarantee or warranties can be given, and any person using this information should rely on their own enquiries.

Upper Level

