



## BAULKHAM HILLS

4  2  2 

Located in the Matthew Pearce catchment area is this single level family home that has so much to offer. Nestled in a sought after, large cul-de-sac on a 701.9sqm block, this is truly a kids' paradise, perfect for bike riding or playing cricket. Offering four bedrooms, with built-in robes to three and the master bedroom features a generous en-suite. This appealing home has excellent living space with an oversized lounge room, a separate dining room and a big rumpus room with a slow combustion fire that warms the whole house in the colder months. Relax & enjoy a BBQ on the deck overlooking the private rear yard with a sparkling pool, whilst the kids play in the cubby house or the huge, built-in sand pit. There is a double lock-up garage with an automatic door & there is plenty of off street parking for more vehicles. Dad will like the free-standing man cave

**Type** : House  
**Land Size** : 701.9 sqm  
**View** : <https://www.gilmour.com.au/sale/nsw/hills/baulkham-hills/residential/house/5620375>



**Craig Alexis**  
02 9899 3311

[For full version visit the website](https://www.gilmour.com.au)

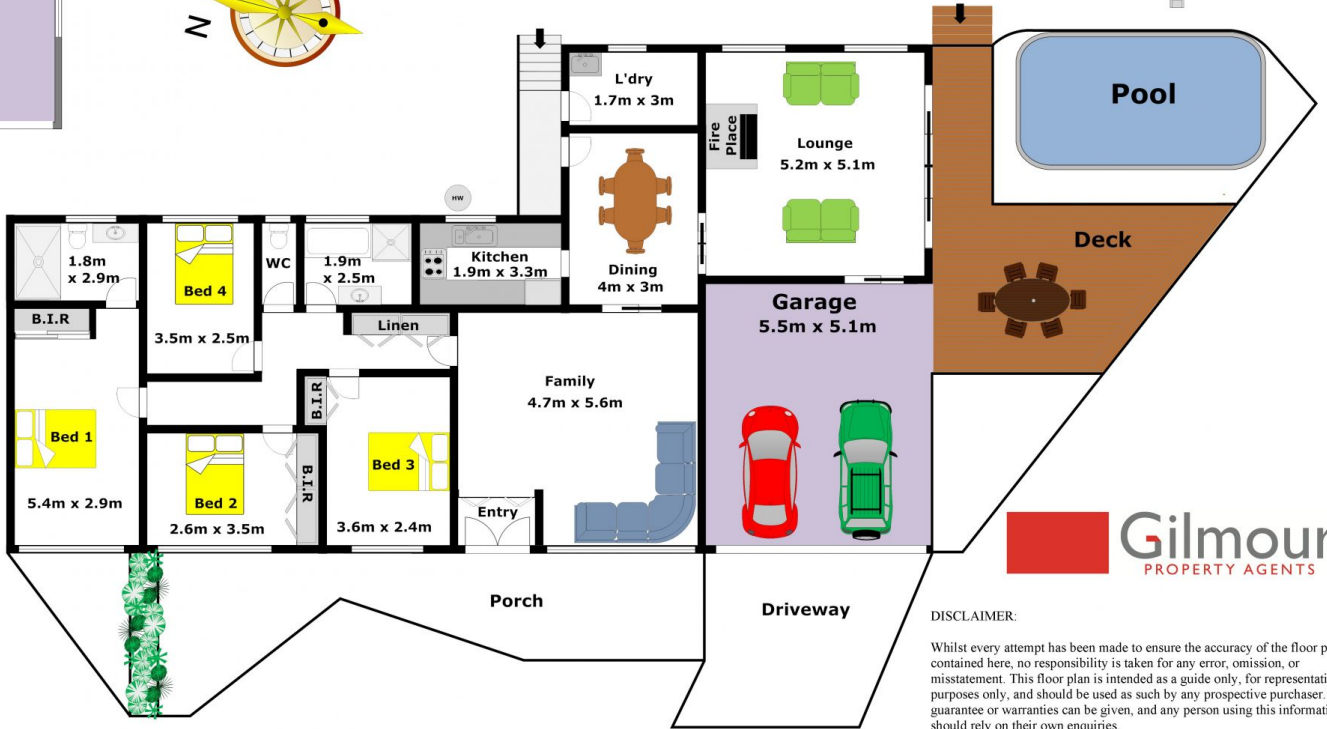
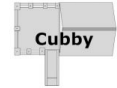

**DISCLAIMER:**

Whilst every attempt has been made to ensure the accuracy of the floor plan contained here, no responsibility is taken for any error, omission, or misstatement. This floor plan is intended as a guide only, for representation purposes only, and should be used as such by any prospective purchaser. No guarantee or warranties can be given, and any person using this information should rely on their own enquiries.