



## 20 Yaringa Road CASTLE HILL NSW

4 3 2

This fantastic family home sits on a 846sqm block on the high side of a fantastic street in the Samuel Gilbert catchment area. Offering four generous bedrooms plus a separate study, with built-in wardrobes to three bedrooms and an enviable walk-in robe & en-suite to the master bedroom. The design of the home is on spacious family living comprising of a formal lounge & dining room with a gas fuelled pot belly heater, a separate rumpus room and a family/meals area adjoining the kitchen. Enjoy the convenience of entertaining outside during all seasons & reasons with the large undercover area that has a gas mains connection for the BBQ and overlooks the lovely grassed yard and large in-ground pool. With other quality inclusions such as ducted air-conditioning, slate tiling, a full third bathroom downstairs and a large double lock-up

**Type** : House  
**Land Size** : 846.8 sqm  
**View** : <https://www.gilmour.com.au/sale/nsw/hills/castle-hill/residential/house/5620368>



**Gilmour Property Agents**  
**02 9899 3311**

[For full version visit the website](https://www.gilmour.com.au)

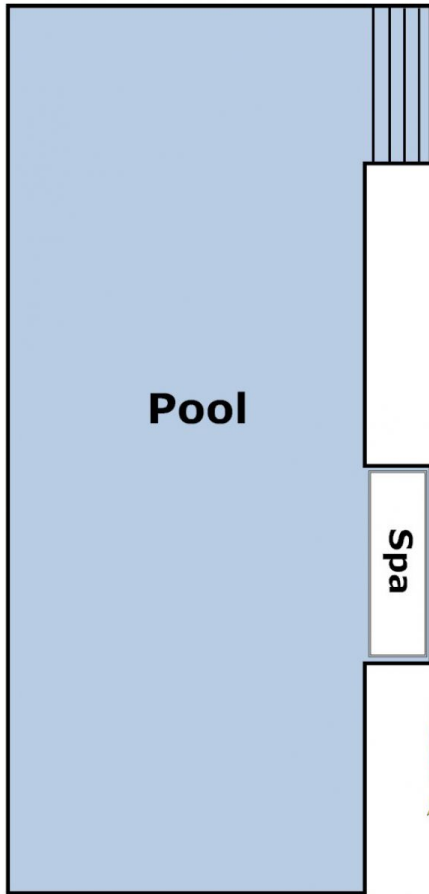

## Upper Level

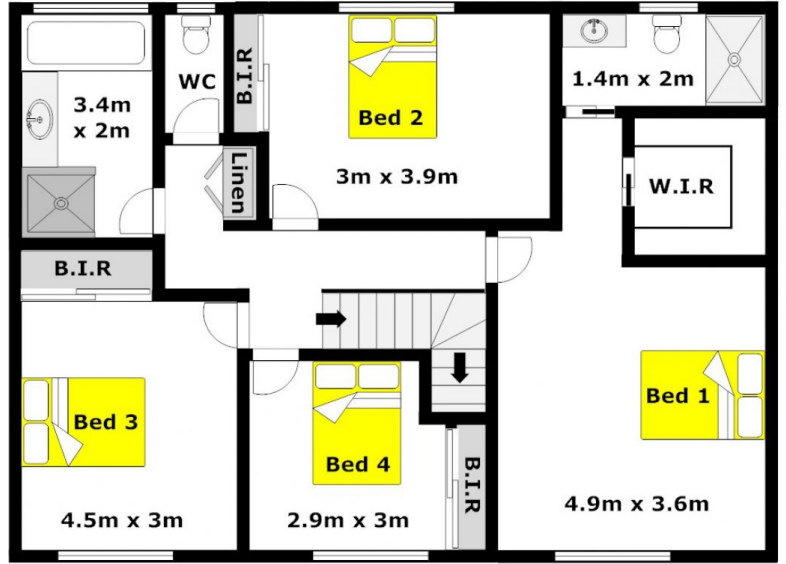

### DISCLAIMER:

Whilst every attempt has been made to ensure the accuracy of the floor plan contained here, no responsibility is taken for any error, omission, or misstatement. This floor plan is intended as a guide only, for representation purposes only, and should be used as such by any prospective purchaser. No guarantee or warranties can be given, and any person using this information should rely on their own enquiries.

