



6 Witonga Crescent BAULKHAM HILLS NSW

3 1 2

Looking for your first home/investment, a property to renovate and extend or a big block to build your dream home? Well here it is! Located in a whisper quiet crescent in the sought after Baulkham Hills North locale is this lovely, single level brick & tile home. Sitting on more than 900sqm with a great back yard and boasting polished floorboards throughout the two bedrooms, a separate study and the lounge & dining area. There is a second living room or potential third bedroom and accommodation for two cars with the double carport plus a man cave under the house for a workshop or storage. Close & convenient to M2 bus city transport, local shops & Stockland Mall and the Baulkham Hills North Primary School. Please make it to the first open house as it is bound to be snapped up quickly!

SOLD 12 December, 2013

[For full version visit the website](https://www.gilmour.com.au)

Type : House
Land Size : 900 sqm
View : <https://www.gilmour.com.au/sale/nsw/hills/baulkham-hills/residential/house/5620352>



Craig Alexis
02 9899 3311

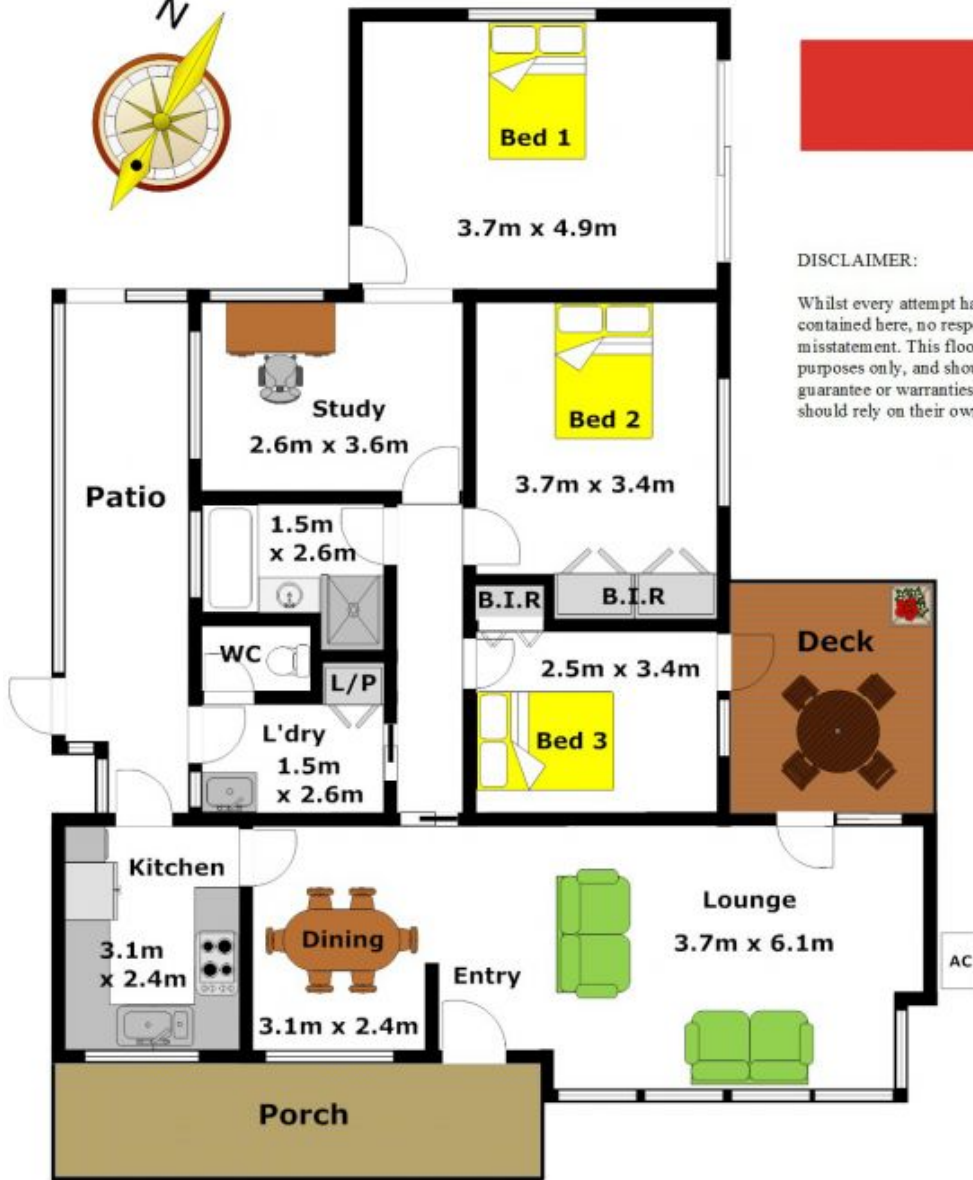

DISCLAIMER:

Whilst every attempt has been made to ensure the accuracy of the floor plan contained here, no responsibility is taken for any error, omission, or misstatement. This floor plan is intended as a guide only, for representation purposes only, and should be used as such by any prospective purchaser. No guarantee or warranties can be given, and any person using this information should rely on their own enquiries.

