





55 Roxborough Park Road CASTLE HILL NSW

3  3  1 

Situated within the highly sought after Roxborough Park estate is this delightful, renovated family home on 695.6sqm. Offering three bedrooms, all with built-in robes and two stylish bathrooms including the en-suite to the master bedroom. Experience the joy of cooking in modern CaesarStone kitchen with gas cooking & stainless steel appliances and then relax & feast in the open plan lounge & dining room. An emphasis on entertaining is here with the huge covered Merbau timber deck that comes complete with a gas heater and a built-in CaesarStone benchtop BBQ that boasts a range hood & sink. From the deck you can watch over the children playing the spacious grassed yard that is framed by established hedges & gardens. With all the creature comforts to make it a home such as polished timber floorboards, ducted air-conditioning, a third

Type : House
Land Size : 695 sqm
View : <https://www.gilmour.com.au/sale/nsw/hills/castle-hill/residential/house/5620348>



Gilmour Property Agents
02 9899 3311

[For full version visit the website](https://www.gilmour.com.au)

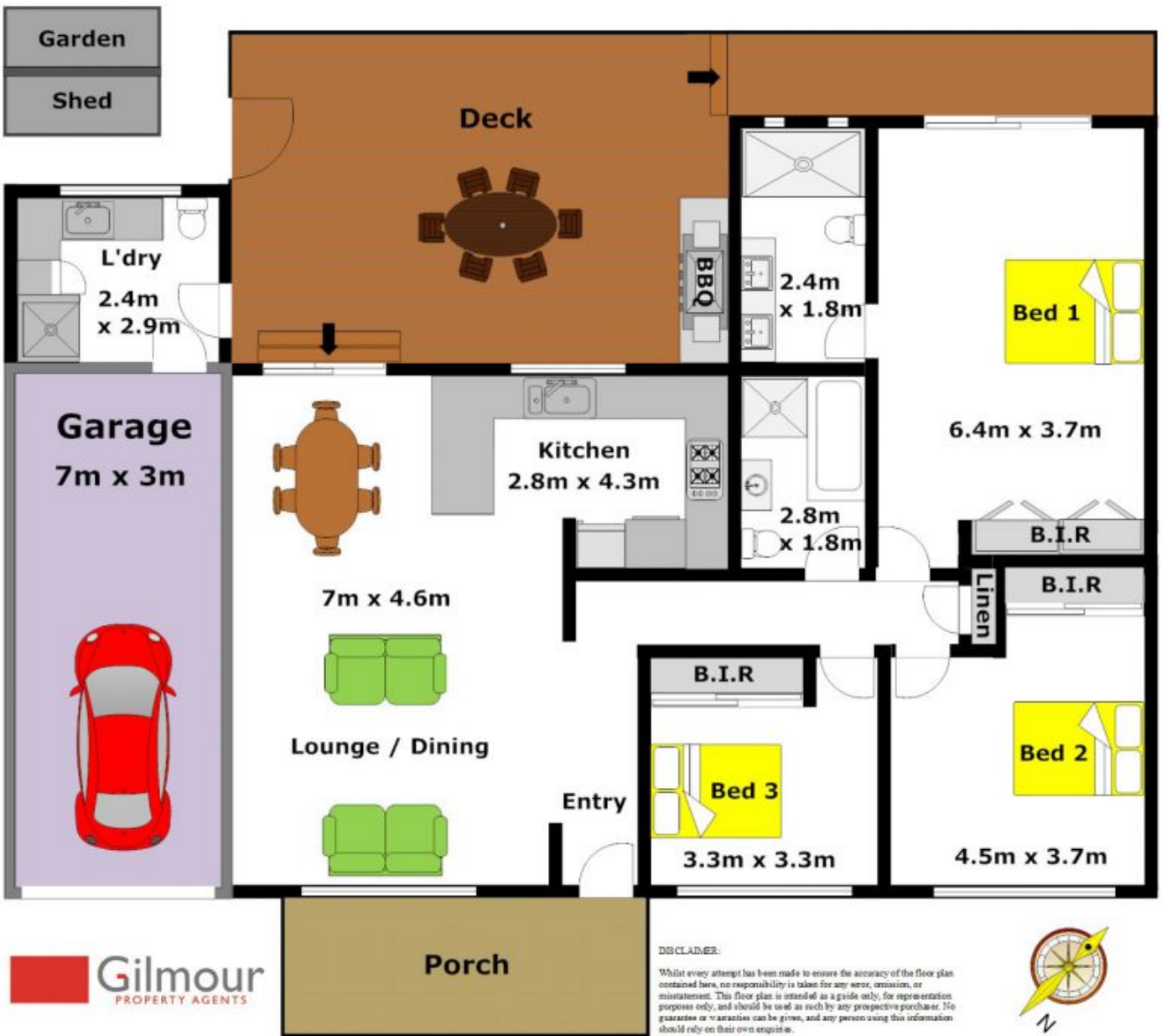

Gilmour
PROPERTY AGENTS

