





25/81-87 Cecil Avenue CASTLE HILL NSW

2  2  2 

Located only a short stroll to cafes and shops is this modern, full brick apartment in a quiet, security complex. Boasting a top floor position and two bedrooms, with a walk-in wardrobe and en-suite unit to the generous master bedroom. The huge open plan layout of the apartment flows out to the large balcony allowing for easy living and entertaining. Whilst you can whip up decidedly delicious dishes in the contemporary kitchen with gas cooking and stainless steel appliances. Other quality features include a gas heating outlet, a tandem lock-up garage and brand new carpet & paint. Situated in a security building with an alarm, lift access and a complex pool & BBQ to enjoy. Close & convenient to the heart of Castle Hill including Castle Towers, restaurants, library, cinemas and city transport - the ideal lifestyle awaits!

[For full version visit the website](https://www.gilmour.com.au/sale/nsw/hills/castle-hill/residential/unit/5620300)

**Type** : Unit  
**Land Size** : 160 sqm  
**View** : <https://www.gilmour.com.au/sale/nsw/hills/castle-hill/residential/unit/5620300>



**Gilmour Property Agents**  
02 9899 3311

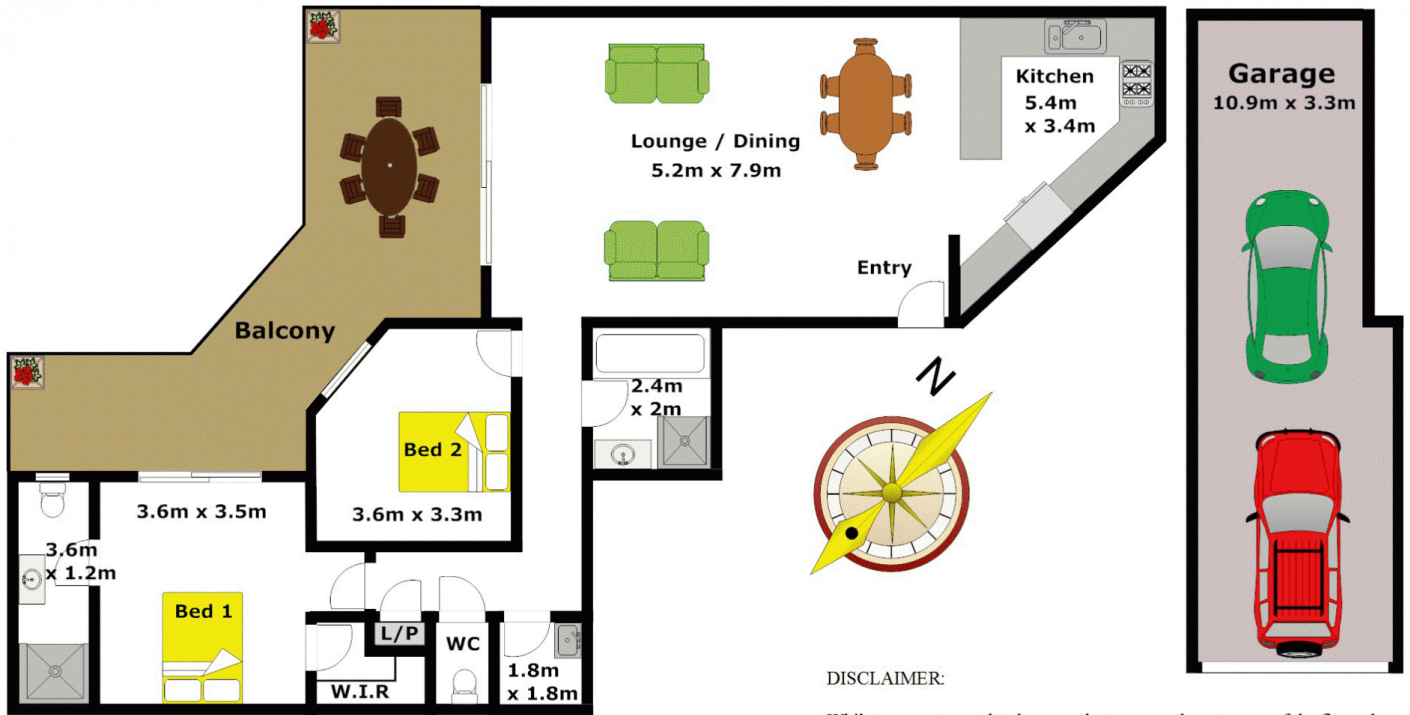

Whilst every attempt has been made to ensure the accuracy of the floor plan contained here, no responsibility is taken for any error, omission, or misstatement. This floor plan is intended as a guide only, for representation purposes only, and should be used as such by any prospective purchaser. No guarantee or warranties can be given, and any person using this information should rely on their own enquiries.