



## CASTLE HILL

3  2  2 

Set in the heart of Castle Hill within enviable proximity to all amenities is this modern townhouse. Boasting three bedrooms, with a walk-in robe & en-suite to the master bedroom and built-in robes to the other two bedrooms. There is an open plan living & meals area that flows into the contemporary kitchen with stainless steel appliances and gas cooking. Enjoy relaxing outside on the paved area and the low maintenance, grassed yard. Other great features include ducted air-conditioning, gas heating connections, additional separate toilet, under stair storage and an automatic double lock-up garage with internal access. Situated in a quiet complex and convenient to all amenities including Castle Towers, restaurants, cinemas, transport, library and schools- be quick with this one!

SOLD 9 May, 2013

[For full version visit the website](https://www.gilmour.com.au)

**Type** : Townhouse  
**Land Size** : 199 sqm  
**View** : <https://www.gilmour.com.au/sale/nsw/hills/castle-hill/residential/townhouse/5620266>



**Gilmour Property Agents**  
02 9899 3311

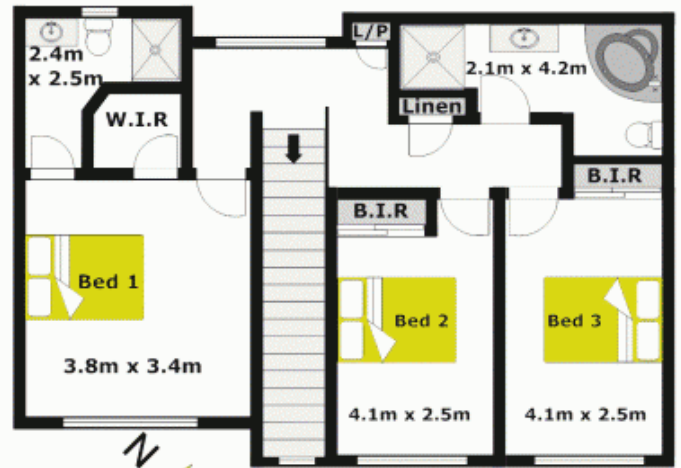
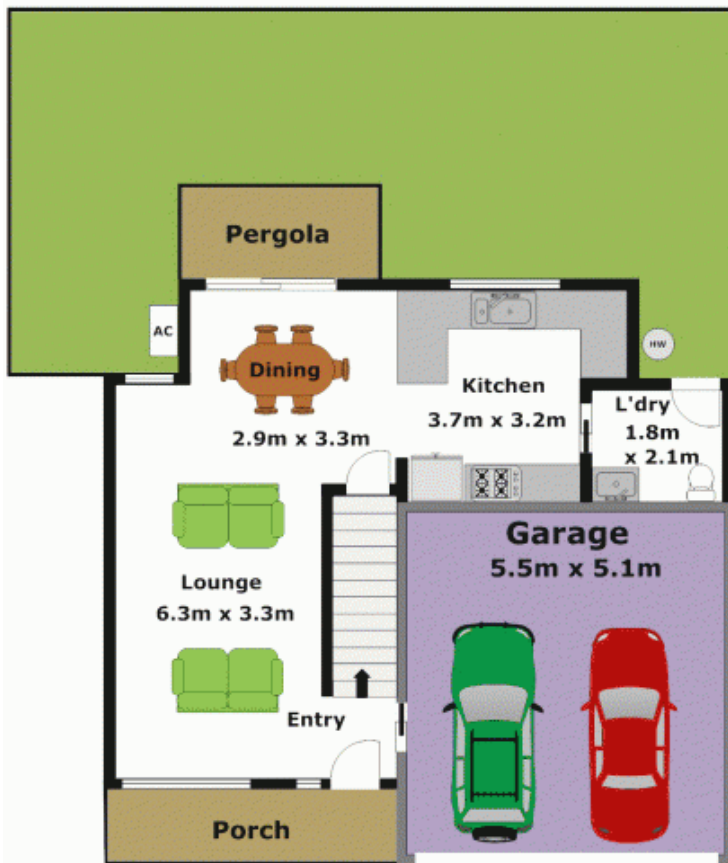

**DISCLAIMER:**

Whilst every attempt has been made to ensure the accuracy of the floor plan contained here, no responsibility is taken for any error, omission, or misstatement. This floor plan is intended as a guide only, for representation purposes only, and should be used as such by any prospective purchaser. No guarantee or warranties can be given, and any person using this information should rely on their own enquiries.