



CASTLE HILL

3  2  2 

This well proportioned modern apartment is situated in an established complex in the heart of Castle Hill. Boasting a total of 195sqm and offering three good sized bedrooms with built-in wardrobes to all & two bathrooms including the en-suite to the master bedroom. With an open plan living and meals area that adjoins the contemporary kitchen with gas cooking and stainless steel appliances. Entertain on the large wrap around, covered balcony and there is a common courtyard area within the complex also. Other features include an automatic double lock-up garage (36sqm), a massive storage room (31sqm) and air-conditioning - all set within a full security complex. Close to all amenities including a short distance to the city express bus. This well presented apartment is a fantastic opportunity not to be missed!

Type : Unit
Land Size : 195 sqm
View : <https://www.gilmour.com.au/sale/nsw/hills/castle-hill/residential/unit/5620252>



Gilmour Property Agents
02 9899 3311

[For full version visit the website](https://www.gilmour.com.au)

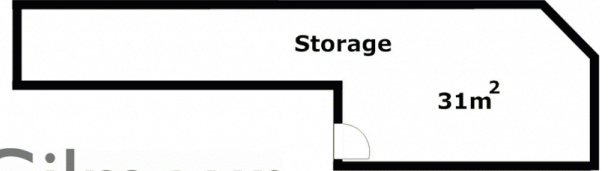
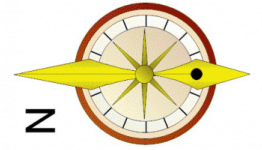
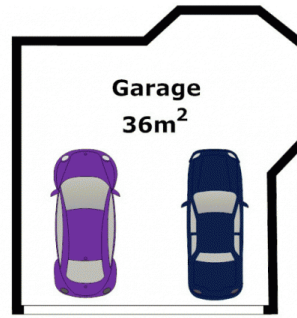
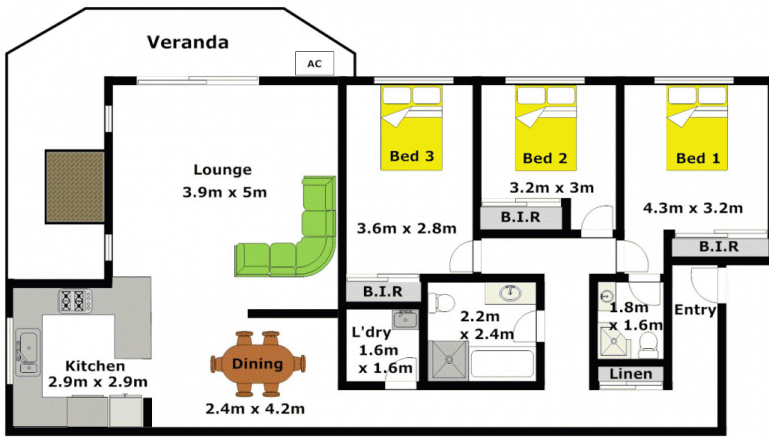

DISCLAIMER:

Whilst every attempt has been made to ensure the accuracy of the floor plan contained here, no responsibility is taken for any error, omission, or misstatement. This floor plan is intended as a guide only, for representation purposes only, and should be used as such by any prospective purchaser. No guarantee or warranties can be given, and any person using this information should rely on their own enquiries.



Gilmour
PROPERTY AGENTS