



## CASTLE HILL

4 2 2

Sitting in a quiet cul-de-sac in a sought after locale is this single level family home on a level 740.5sqm. Offering four generous bedrooms with built-in robes to three and a walk-in robe plus en-suite to the master bedroom. There are generous living areas of a formal lounge & dining room, a separate rumpus room and a family/meals area adjoining the roomy kitchen. Enjoy entertaining outside under the large paved pergola and the kids will love to splash about & play in the in-ground salt water pool and grassed area. Other great features of this home include ducted air-conditioning and a double lock-up garage. Conveniently close to Samuel Gilbert Public, Knightsbridge shops and public transport-a home not to be missed!  
SOLD 11 February, 2013

**Type** : House  
**Land Size** : 740.5 sqm  
**View** : <https://www.gilmour.com.au/sale/nsw/hills/castle-hill/residential/house/5620232>



**Gilmour Property Agents**  
**02 9899 3311**

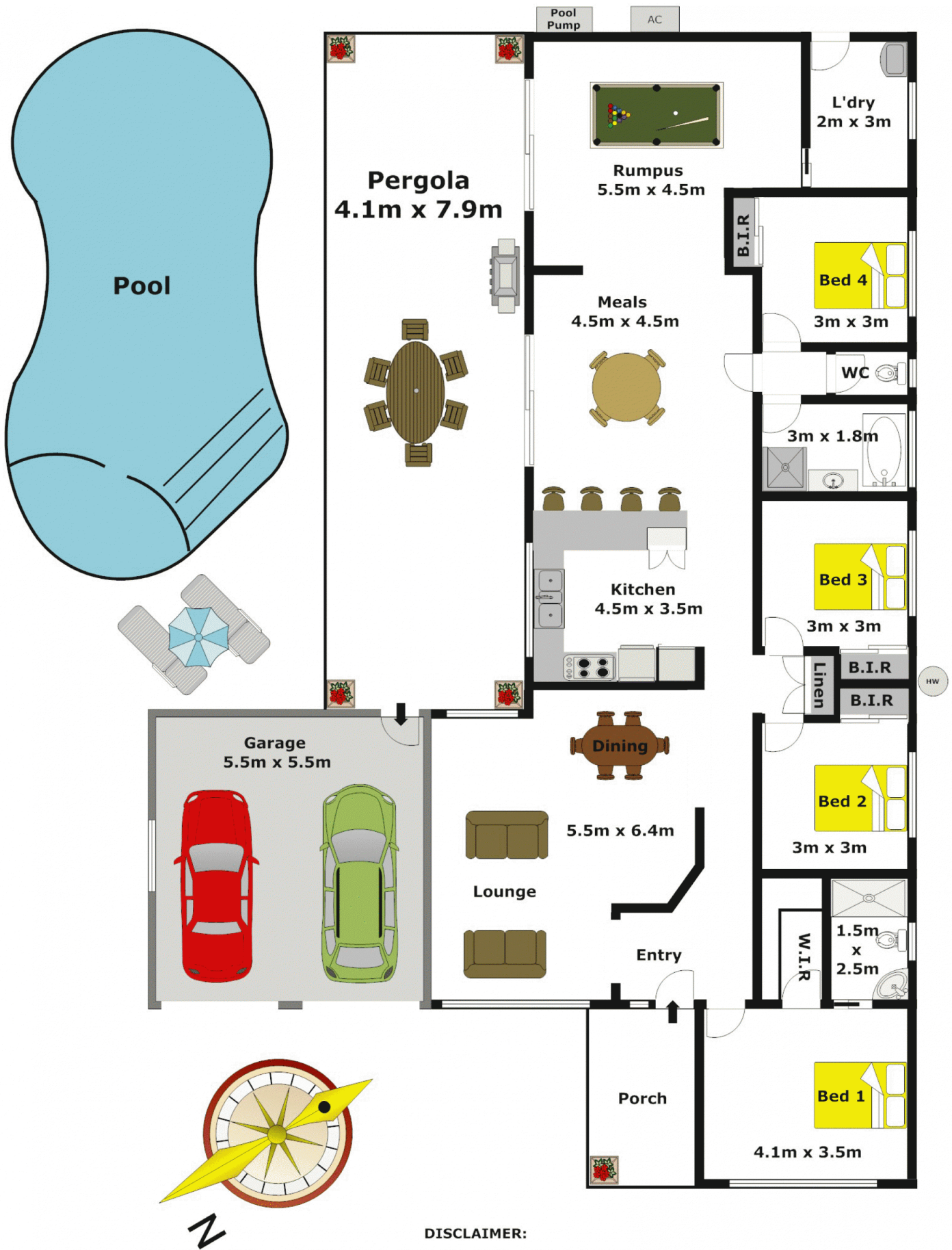

**DISCLAIMER:**

Whilst every attempt has been made to ensure the accuracy of the floor plan contained here, no responsibility is taken for any error, omission, or miss-statement. This floor plan is intended as a guide only, for representation purposes only, and should be used as such by any prospective purchaser. No guarantee or warranties can be given, and any person using this information should rely on their own enquires.