



CASTLE HILL

4 3 2

Situated in one of Castle Hill's finest estates is this large north facing family home on a level, regular shaped 800sqm block. Boasting plenty of room for a large family with four bedrooms upstairs all with built-in wardrobes, a fifth bedroom/study downstairs and a total of three bathrooms including an en-suite to the master bedroom.

This first time to the market, one owner home will impress with its new carpet & paint and generous living areas that include a formal lounge & formal dining room, separate rumpus and informal dining area. Established gardens frame the private & fenced yard that comes complete with a sparkling, salt-water in-ground pool and a paved & covered entertaining area. Other great features include air-conditioning, two garden sheds, side access and a double lock-up garage. Only a short distance to Samuel

Type : House
Land Size : 800 sqm
View : <https://www.gilmour.com.au/sale/nsw/hills/castle-hill/residential/house/5620227>



Gilmour Property Agents
02 9899 3311

[For full version visit the website](https://www.gilmour.com.au)

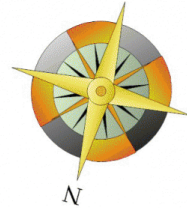
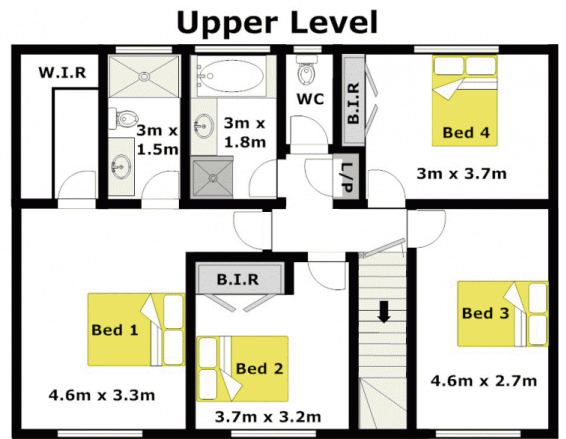

DISCLAIMER:

Whilst every attempt has been made to ensure the accuracy of the floor plan contained here, no responsibility is taken for any error, omission, or misstatement. This floor plan is intended as a guide only, for representation purposes only, and should be used as such by any prospective purchaser. No guarantee or warranties can be given, and any person using this information should rely on their own enquiries.