



CASTLE HILL

4 2

Situated in the heart of Castle Hill on the high side of a quiet street on 708sqm is this single level family home that is bigger than it looks and has a refreshing in-ground pool in the backyard! Full of charming character inside with high 9 foot ceilings & four generous size bedrooms all with built-in wardrobes plus the master bedroom boasts a modern en-suite complete with spa along with the main bathroom & laundry. You'll enjoy the modern gourmet kitchen and oodles of formal & informal living areas. The split air-conditioning system helps keep the seasonal variations in temperature pleasant all year round. There is an awesome paved pergola ideal for entertaining, to enjoy a BBQ or simply relaxing with friends or family and it also looks onto the grassed yard for the kids to play in safety. Conveniently close to all amenities including within walking

Type : House
Land Size : 708 sqm
View : <https://www.gilmour.com.au/sale/nsw/hills/castle-hill/residential/house/5620224>



Craig Alexis
02 9899 3311

[For full version visit the website](https://www.gilmour.com.au)

DISCLAIMER:

Whilst every attempt has been made to ensure the accuracy of the floor plan contained here, no responsibility is taken for any error, omission, or misstatement. This floor plan is intended as a guide only, for representation purposes only, and should be used as such by any prospective purchaser. No guarantee or warranties can be given, and any person using this information should rely on their own enquiries.

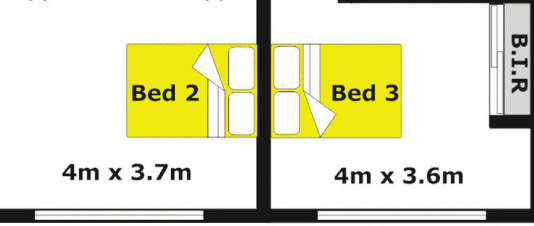
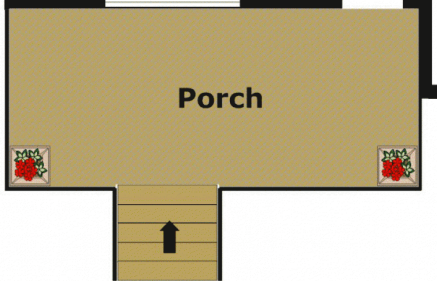
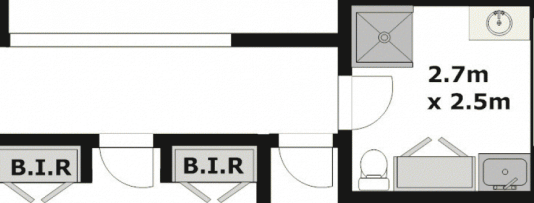
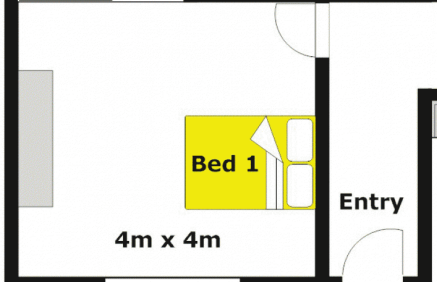
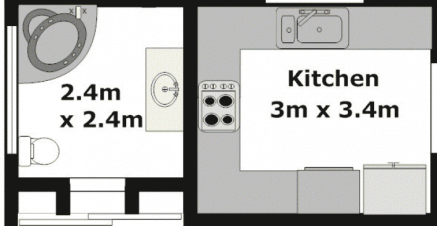
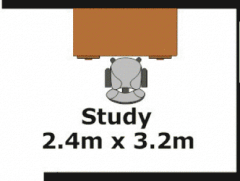
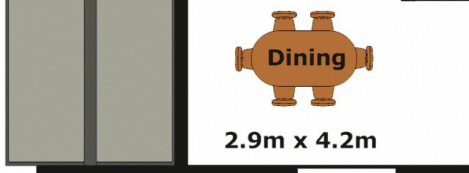
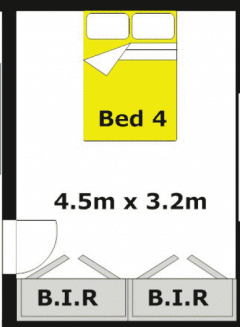
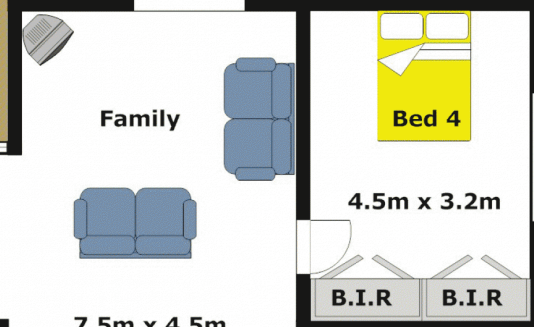
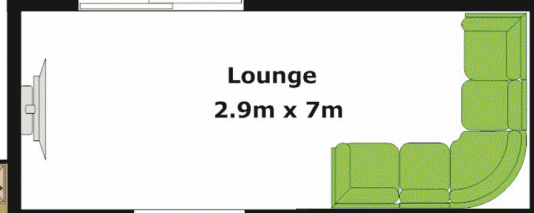
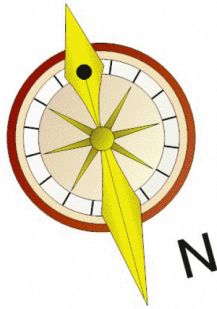
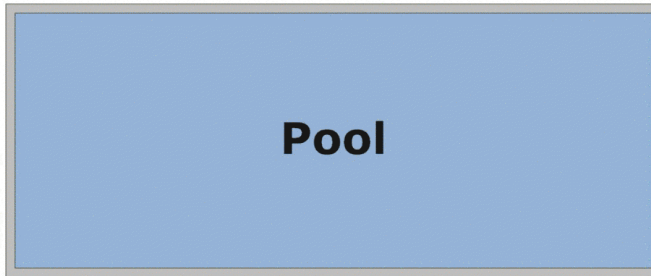

AC