



BAULKHAM HILLS

4 2 2

Situated on the high side of a quiet cul-de-sac located in the popular "Roxborough Park Estate" is this solid family home on 708sqm. Offering four large bedrooms plus a separate study & office and the two bathrooms including the en-suite have been updated. There are high 8 foot 6 ceilings & polished floorboards that compliment the generous lounge & dining room and the informal meals area adjoining the updated granite kitchen with a gas cook top. Enjoy sitting out on the deck and entertaining family & friends whilst keeping an eye on children playing in the large salt water, in-ground pool. Also boasting a downstairs rumpus room with storage space, ducted air-conditioning and a automatic double lock-up garage with internal access. A great combination of features that is perfect for a home business or serious hobby and is close to all

Type : House
Land Size : 708 sqm
View : <https://www.gilmour.com.au/sale/nsw/hills/baulkham-hills/residential/house/5620204>



Gilmour Property Agents
02 9899 3311

[For full version visit the website](https://www.gilmour.com.au)

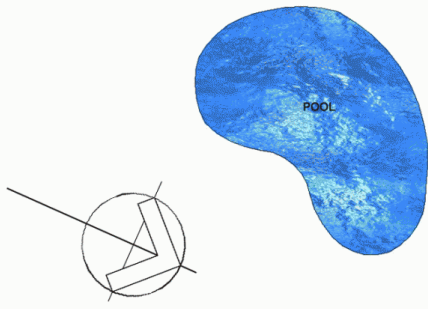

FIRST FLOOR

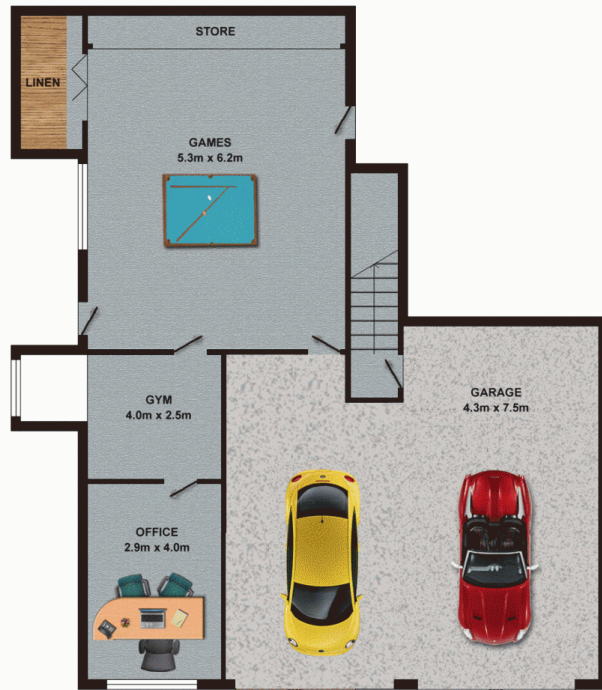

GROUND FLOOR

DISCLAIMER
 DIMENSIONS ARE APPROXIMATE AND SHOULD ONLY BE USED AS A GUIDE
 THEY ARE NOT TO SCALE AND NO LIABILITY WILL BE ACCEPTED.



Gilmour
 PROPERTY AGENTS