



KELLYVILLE RIDGE

This four year young Masterton home of 29 squares is perfect for those seeking style, substance and quality in a low maintenance property. Set on 500.6sqm and boasting four bedrooms with built-in wardrobes to three and a walk-in robe plus ensuite to the master bedroom. The clever design of the home has created separate living spaces whilst preserving the natural flow & clean lines. The CasesarStone & Polyurethane kitchen with stainless steel appliances allows you to cook and talk with the rest of the family. Enjoy outdoor entertaining with the covered & paved area and grassed yard plus there is a pool, tennis court & BBQ within the community facilities. Other great features include a garden shed, ducted vacuum, alarm, ducted air-conditioning, large automatic double garage with internal access and plantation shutters to the front of the

4  2  2 

Type : House
Land Size : 500.6 sqm
View : <https://www.gilmour.com.au/sale/nsw/hills/kellyville-ridge/residential/house/5620115>



Gilmour Property Agents
02 9899 3311

[For full version visit the website](https://www.gilmour.com.au)

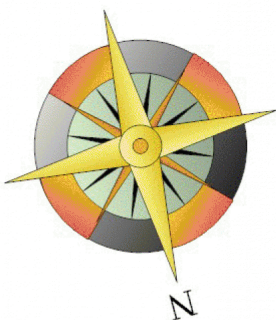
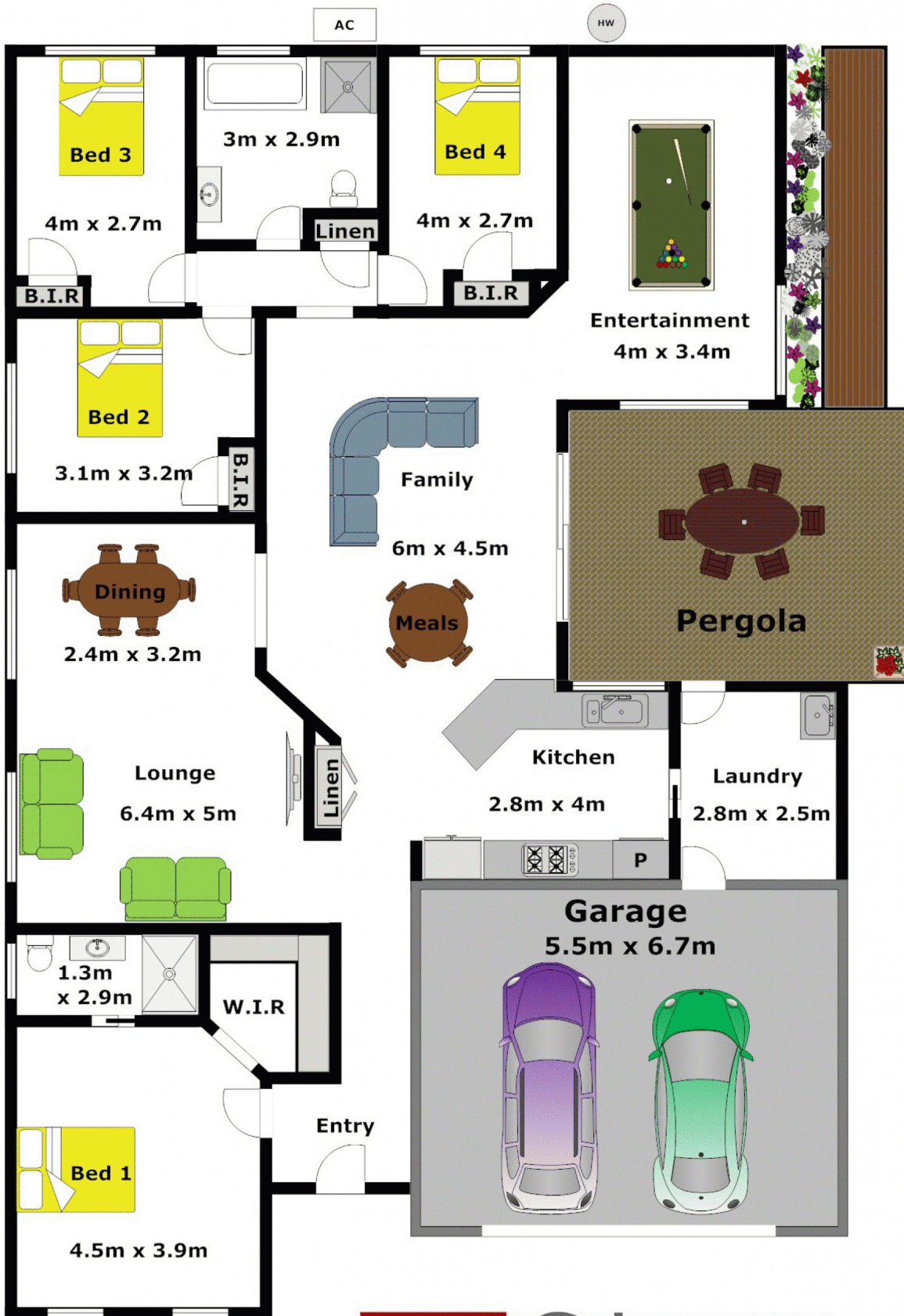

DISCLAIMER:

Whilst every attempt has been made to ensure the accuracy of the floor plan contained here, no responsibility is taken for any error, omission, or misstatement. This floor plan is intended as a guide only, for representation purposes only, and should be used as such by any prospective purchaser. No guarantee or warranties can be given, and any person using this information should rely on their own enquires.