



## CASTLE HILL

5 3 3

This single level family home sitting on a huge 1,144sqm block in a quiet street is sure to meet the needs of a growing family. Offering five bedrooms with built-in robes to all and a walk-in robe plus ensuite to the master. With a separate wing to the home containing the fifth bedroom which features an ensuite and could serve as a teenagers retreat or guest accommodation. Space for the whole family to spread out with the lounge room, dining and a large rumpus room featuring a fireplace & bar. Enjoy cooking up a storm in the modern kitchen with stone benchtops and stainless steel appliances plus there is a meals area adjoining. Jump in and cool off in the warmer months in the sparkling in-ground, salt water pool with a cabana. Completing the package of this home is the automatic triple lock-up garage, ducted air-conditioning and

**Type** : House  
**Land Size** : 1144 sqm  
**View** : <https://www.gilmour.com.au/sale/nsw/hills/castle-hill/residential/house/5620112>



**Gilmour Property Agents**  
**02 9899 3311**

[For full version visit the website](https://www.gilmour.com.au)

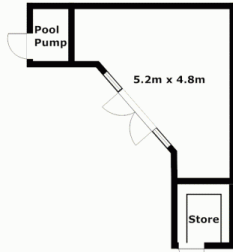
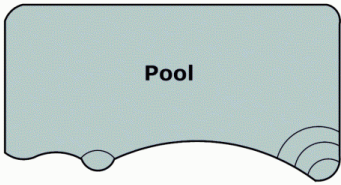

**DISCLAIMER:**

Whilst every attempt has been made to ensure the accuracy of the floor plan contained here, no responsibility is taken for any error, omission, or misstatement. This floor plan is intended as a guide only, for representation purposes only, and should be used as such by any prospective purchaser. No guarantee or warranties can be given, and any person using this information should rely on their own enquires.

