





## CASTLE HILL

2  2  2 

Ideally located in central Castle Hill is this spacious and modern apartment positioned on the ground floor in a prestigious, security complex. Offering two large bedrooms with built-in wardrobes to both and two bathrooms including the ensuite to the master bedroom. With a combination of a large, open plan layout and clever design to create separate living areas. This modern granite & polyurethane kitchen was designed for people who like to cook and entertain at the same time-boasting gas cooking and stainless steel appliances. The balcony and private entertaining courtyard allows you to maintain your individual lifestyle whilst hosting family and friends. Other great features include a split system air-conditioning unit, pool in the complex, floating timber floors and double lock-up garage. Total size of the apartment including the

**Type** : Unit  
**Building Size** : 22 sqm  
**View** : <https://www.gilmour.com.au/sale/nsw/hills/castle-hill/residential/unit/5620107>



**Gilmour Property Agents**  
**02 9899 3311**

[For full version visit the website](https://www.gilmour.com.au)

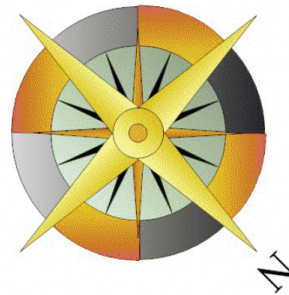
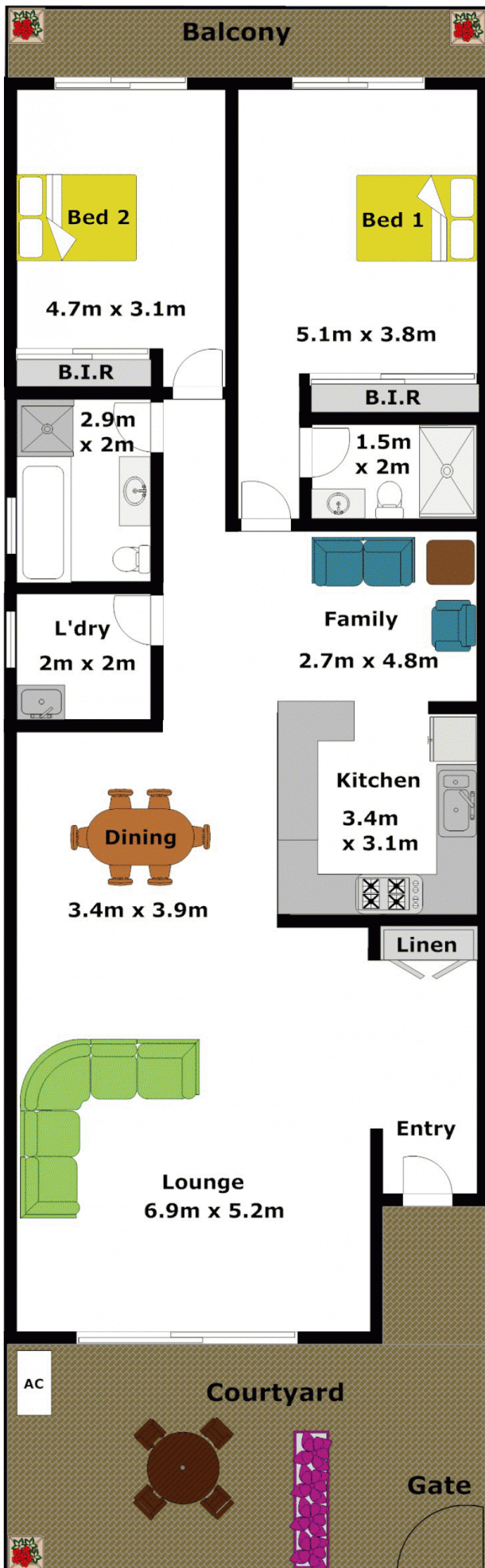

**DISCLAIMER:**

Whilst every attempt has been made to ensure the accuracy of the floor plan contained here, no responsibility is taken for any error, omission, or misstatement. This floor plan is intended as a guide only, for representation purposes only, and should be used as such by any prospective purchaser. No guarantee or warranties can be given, and any person using this information should rely on their own enquires.

