



## CASTLE HILL

4  2  2 

Situated in the desirable Castlewood Estate is this lovingly cared for family home on a level & square 800sqm block. Set amongst other quality homes and offering four bedrooms with built-in wardrobes to three and an ensuite to the master bedroom. An opportunity to enjoy both formal and informal living is provided with the large formal lounge, separate dining room and a family meals room adjoining the renovated, contemporary gas kitchen. The outdoor entertaining area suits all occasions and conditions with a paved undercover pergola which looks out onto the lovely, generous backyard with an elevated outlook and room for a pool. The neat & tidy home incorporates features such as double lock-up garage with internal access, additional separate toilet, wide side access, fully fenced yard, gas bayonets and the carpet & paint is only 5 years old. Ideally

**Type** : House  
**Land Size** : 800 sqm  
**View** : <https://www.gilmour.com.au/sale/nsw/hills/castle-hill/residential/house/5620106>



**Gilmour Property Agents**  
**02 9899 3311**

[For full version visit the website](https://www.gilmour.com.au)

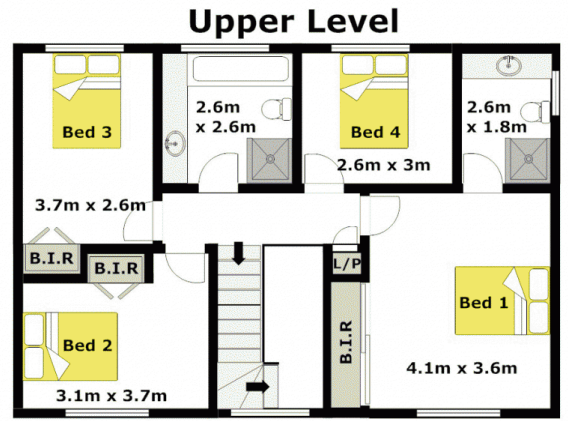
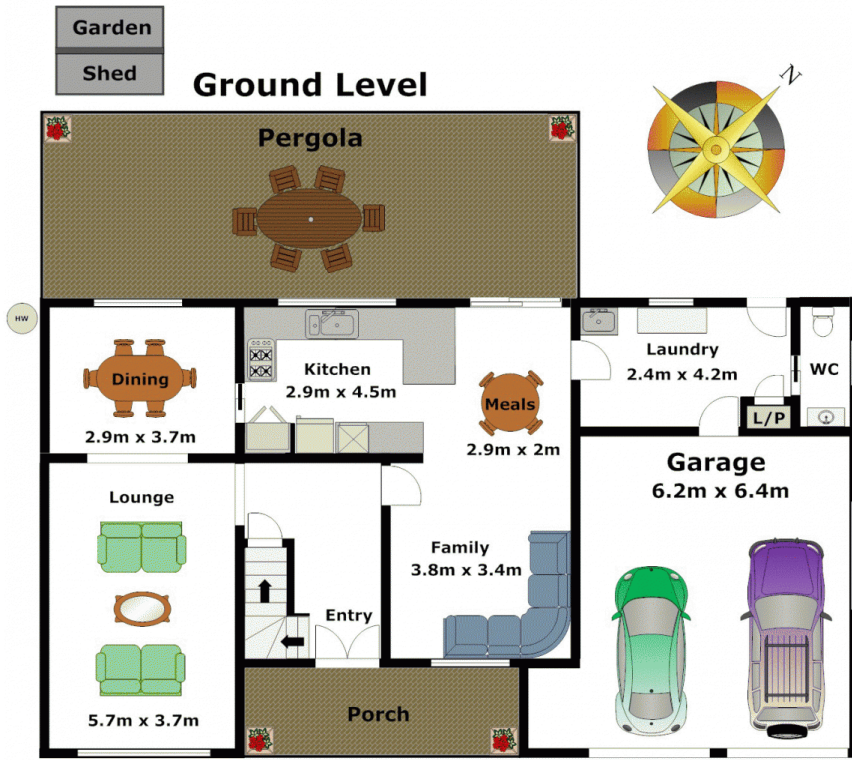

**DISCLAIMER:**

Whilst every attempt has been made to ensure the accuracy of the floor plan contained here, no responsibility is taken for any error, omission, or misstatement. This floor plan is intended as a guide only, for representation purposes only, and should be used as such by any prospective purchaser. No guarantee or warranties can be given, and any person using this information should rely on their own enquires.

