



CASTLE HILL

4 3 2

If You Have a Family-We Have The House!

Set in an exclusive, quiet cul-de-sac is this great family home on a 812sqm block (approximately) within the Samuel Gilbert catchment area. Offering four bedrooms plus study, with built-in wardrobes to three and the master bedroom boasts a walk-in robe plus ensuite. Spacious living areas include a formal lounge & formal dining, rumpus and family/meals area adjoining the kitchen. Relax out on the decking and admire the views out to the mountains whilst also keeping an eye on the children playing in the large grassed yard with side access. Completing the package of this home is ducted air-conditioning and the double lock-up garage with internal access. All within convenient proximity to shops, public transport including city bus and sought after

Type : House
Land Size : 812 sqm
View : <https://www.gilmour.com.au/sale/nsw/hills/castle-hill/residential/house/5620078>



Gilmour Property Agents
02 9899 3311

[For full version visit the website](https://www.gilmour.com.au)

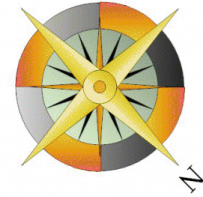
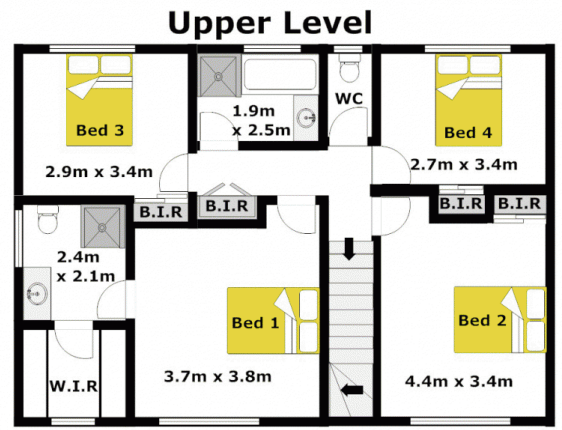
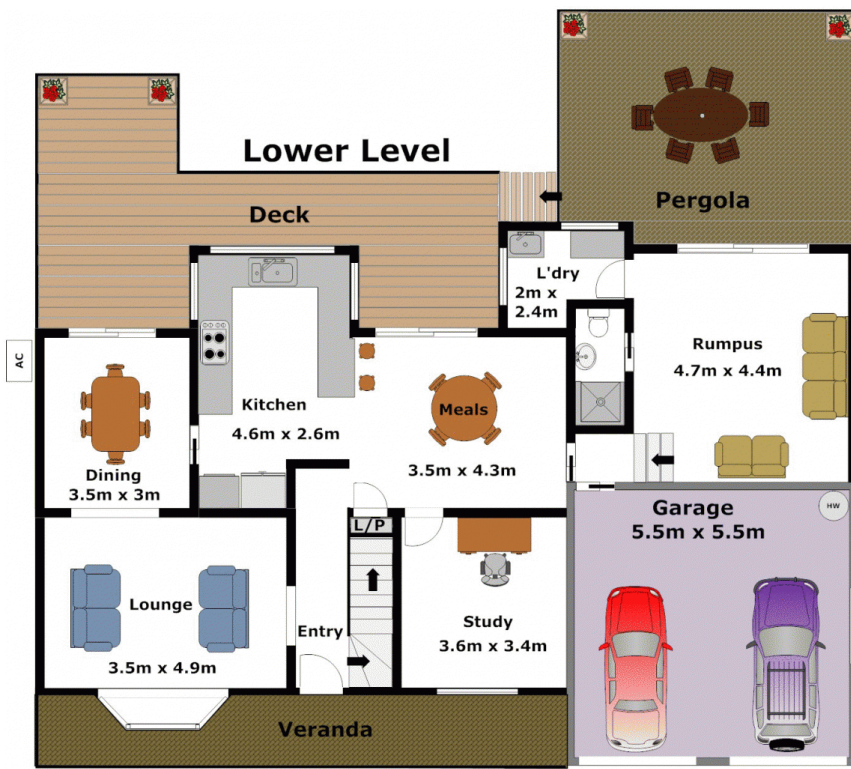

DISCLAIMER:

Whilst every attempt has been made to ensure the accuracy of the floor plan contained here, no responsibility is taken for any error, omission, or misstatement. This floor plan is intended as a guide only, for representation purposes only, and should be used as such by any prospective purchaser. No guarantee or warranties can be given, and any person using this information should rely on their own enquires.

