



## CASTLE HILL

4  2  2 

Set in the sought after Castlewood estate is this fantastic family home on a huge 1020sqm block in a quiet cul-de-sac. A home that is ideal for the growing family and boasting four bedrooms with built-in wardrobes plus study and two bathrooms. With inviting living areas such as the formal lounge room with fireplace, generous family room with polished floorboards and dining room adjoining the Ceasarstone kitchen with Miele appliances. The huge rumpus with a Ceasarstone wet bar is perfecting for hosting friends and family or even a teenagers retreat. The kids will love the grassed front and back yards that both have more than enough space for a game of cricket, kicking the footy around or a pool! Other great features include a huge double lock-up garage with internal access room for a workshop or storage, garden shed and side access. All this

**Type** : House  
**Land Size** : 1020 sqm  
**View** : <https://www.gilmour.com.au/sale/nsw/hills/castle-hill/residential/house/5620073>



**Gilmour Property Agents**  
**02 9899 3311**

[For full version visit the website](https://www.gilmour.com.au)

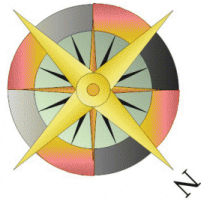
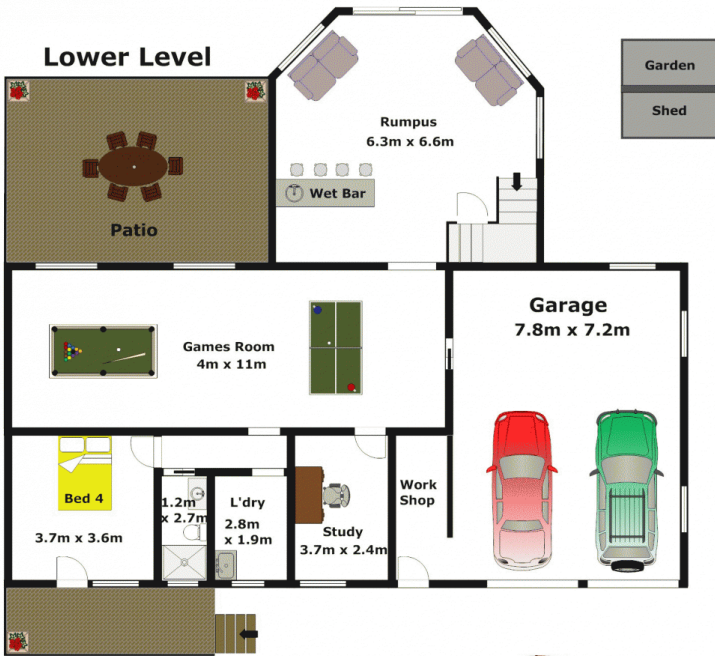

**DISCLAIMER:**

Whilst every attempt has been made to ensure the accuracy of the floor plan contained here, no responsibility is taken for any error, omission, or misstatement. This floor plan is intended as a guide only, for representation purposes only, and should be used as such by any prospective purchaser. No guarantee or warranties can be given, and any person using this information should rely on their own enquires.