



GLENWOOD

4  2  2 

All the bells & whistles are here with this terrific family home on a level

662sqm block with side access. This great size home is almost 30 squares & has four bedrooms and a large study with built-in wardrobes to all the bedrooms and the master has a walk in robe plus ensuite. Living space consists of a lounge & dining, a family meals area off the gas eat-in kitchen with a pantry and there is a family relaxing area as well. Enjoy the polished floorboards upstairs and the separate rumpus room with a gas connection. You will love the perfect sunny north aspect to the back yard when you are having fun in the solar heated, salt water in-ground pool or entertaining under the large wrap around covered pergola. All this and ducted air conditioning plus a double auto garage with drive through & internal access. Move in

Type : House
Land Size : 662 sqm
View : <https://www.gilmour.com.au/sale/nsw/western-sydney/glenwood/residential/house/5620067>



Craig Alexis
02 9899 3311

[For full version visit the website](#)

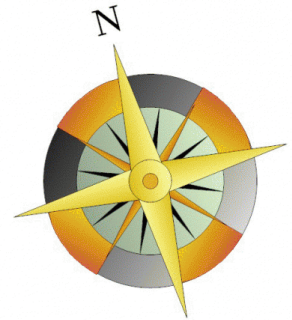
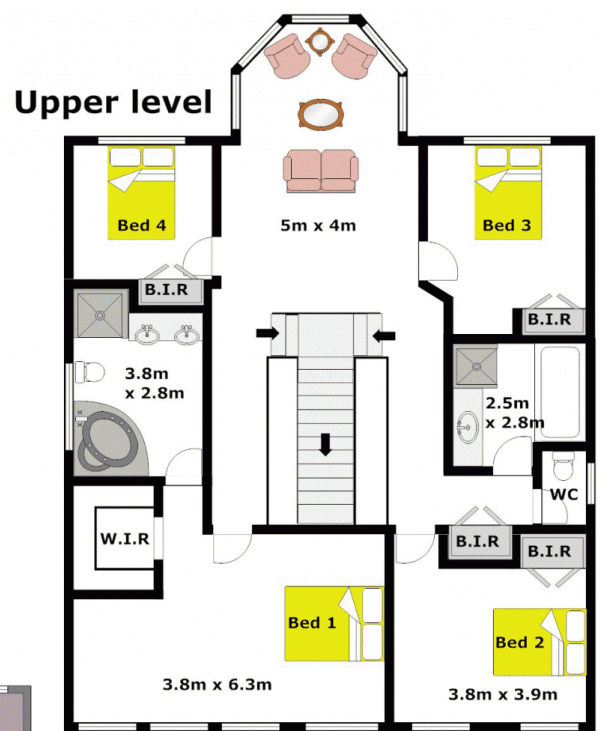
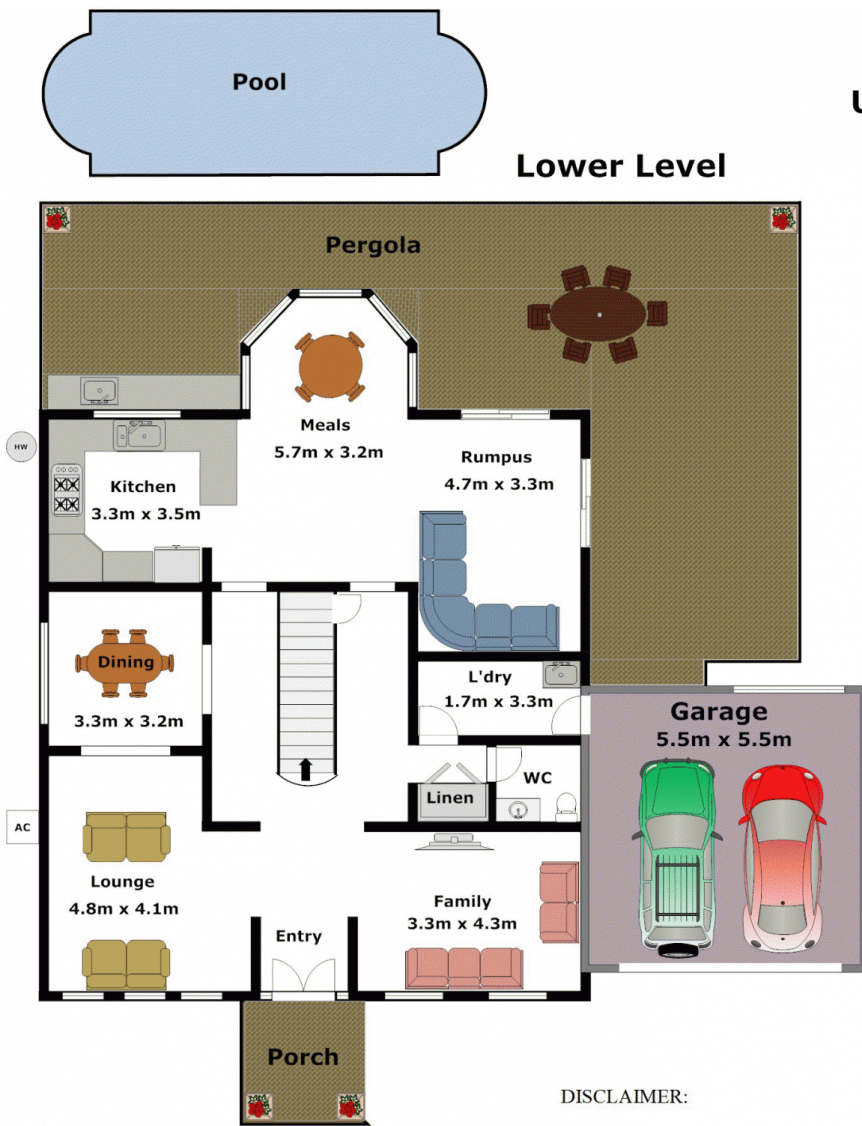

DISCLAIMER:

Whilst every attempt has been made to ensure the accuracy of the floor plan contained here, no responsibility is taken for any error, omission, or misstatement. This floor plan is intended as a guide only, for representation purposes only, and should be used as such by any prospective purchaser. No guarantee or warranties can be given, and any person using this information should rely on their own enquires.

