



## CASTLE HILL

3  1  2 

Situated in the center of Castle Hill within a complex of only 13 is this single level, spacious villa boasting only one common wall. Offering three massive bedrooms all with built-in wardrobes and spacious combined living areas plus a meals area adjoins the functional kitchen. Enjoy outdoor entertaining with the covered area that benefits from the leafy & tranquil setting. With a double lock-up garage and cul-de-sac location with minutes to Castle Towers, schools, library and public transport including express bus to the city-a great opportunity for first home buyer, astute investors or those wanting low-maintenance living! Be quick to inspect

SOLD 4 November, 2011

**Type** : Villa

**View** : <https://www.gilmour.com.au/sale/nsw/hills/castle-hill/residential/villa/5620064>



**Gilmour Property Agents**  
**02 9899 3311**

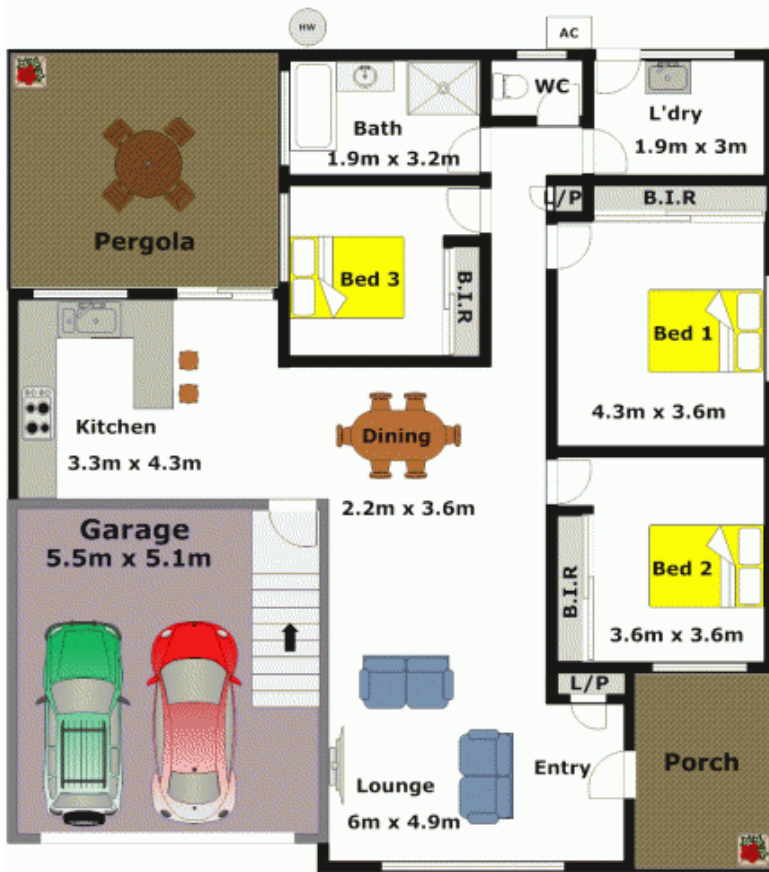

APPROXIMATE INTERNAL FLOOR AREA: 105m<sup>2</sup> (11sq)  
 APPROXIMATE GARAGE FLOOR AREA: 28m<sup>2</sup> (3sq)

**APPROXIMATE TOTAL INTERNAL FLOOR AREA: 133m<sup>2</sup> (14sq)**

**DISCLAIMER:**

Whilst every attempt has been made to ensure the accuracy of the floor plan contained here, no responsibility is taken for any error, omission, or misstatement. This floor plan is intended as a guide only, for representation purposes only, and should be used as such by any prospective purchaser. No guarantee or warranties can be given, and any person using this information should rely on their own enquires.

