



## CASTLE HILL

4 3 2

This single level family, character home is situated in the heart of Castle Hill on a 866sqm block. This unique & lovely home offers three bedrooms with built-in wardrobes in the main residence and a self contained flat at the rear.

The polished timber and slate flooring compliment the light, bright & airy living spaces with a lovely kitchen and adjoining meals area. The rear huge pergola boasts an undercover pool & entertaining area plus the yard has grassed areas for the kids to play. Close & convenient to all amenities with only minutes walk to Castle Towers, schools and public transport.

SOLD 21 November, 2011

**Type** : House  
**Land Size** : 866 sqm  
**View** : <https://www.gilmour.com.au/sale/nsw/hills/castle-hill/residential/house/5620061>



**Gilmour Property Agents**  
02 9899 3311

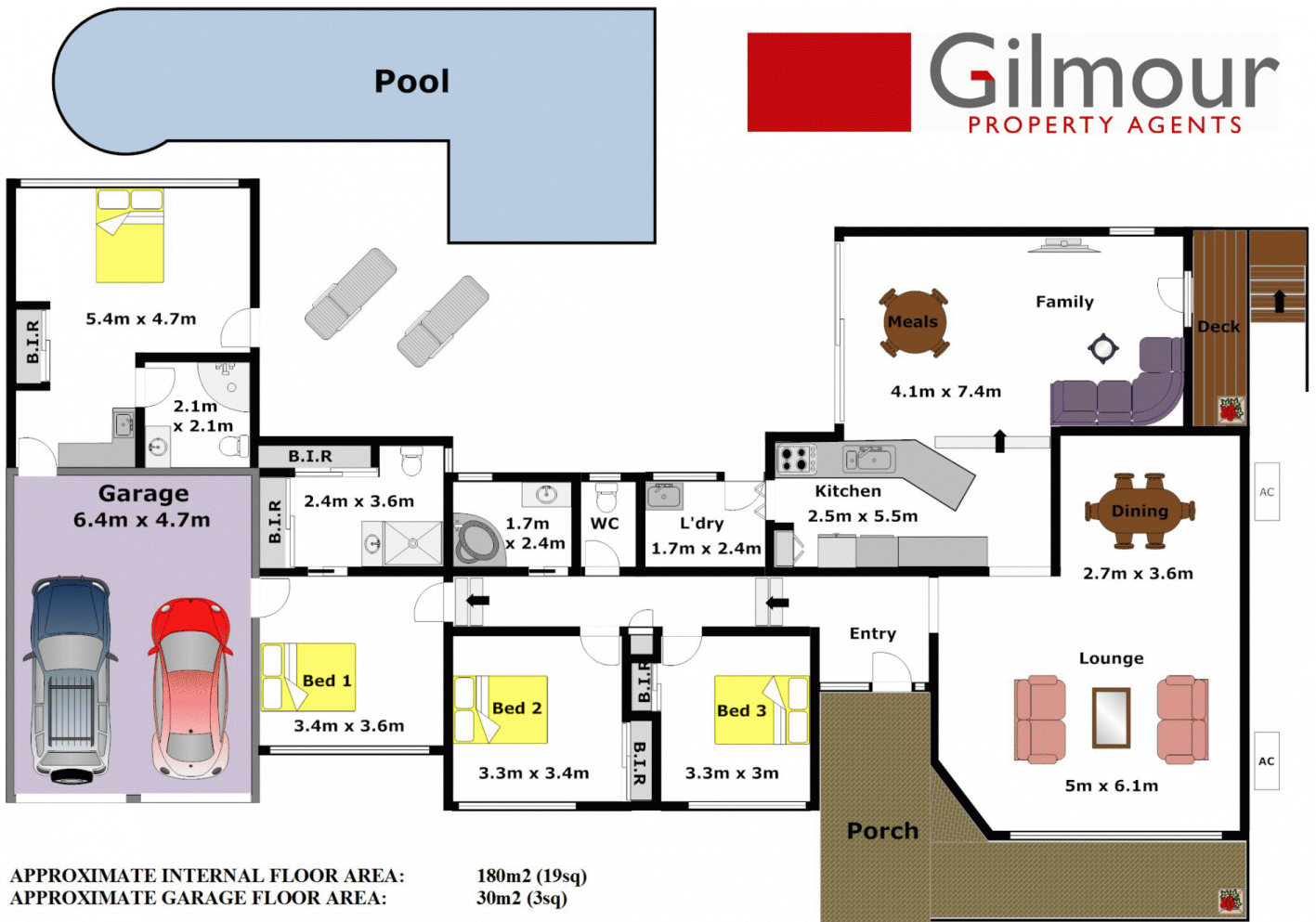

APPROXIMATE INTERNAL FLOOR AREA: 180m<sup>2</sup> (19sq)  
 APPROXIMATE GARAGE FLOOR AREA: 30m<sup>2</sup> (3sq)

**APPROXIMATE TOTAL INTERNAL FLOOR AREA: 210m<sup>2</sup> (22sq)**

**DISCLAIMER:**

Whilst every attempt has been made to ensure the accuracy of the floor plan contained here, no responsibility is taken for any error, omission, or misstatement. This floor plan is intended as a guide only, for representation purposes only, and should be used as such by any prospective purchaser. No guarantee or warranties can be given, and any person using this information should rely on their own enquires.

