



CASTLE HILL

4 2 1

Set in a leafy cul-de-sac is this single level family home on a 700sqm block in enviable proximity to all Castle Hill has to offer. Featuring four great bedrooms, three with built-in wardrobes and ensuite in master. With a lounge room for relaxing and polished floorboards compliment the meals area adjoining the modern kitchen that looks onto the decking and yard. Great undercover timber deck is perfect for entertaining whilst keeping an eye on the children playing in the family friendly yard backing onto the park. Ducted air-conditioning for temperature control and single lock-up garage plus plenty of off street parking. Short distance to Castle Hill Public & Castle Hill High, Castle Towers, public transport and local clubs.
SOLD 6th May, 2011

Type : House
Land Size : 700 sqm
View : <https://www.gilmour.com.au/sale/nsw/hills/castle-hill/residential/house/5620007>



Gilmour Property Agents
02 9899 3311

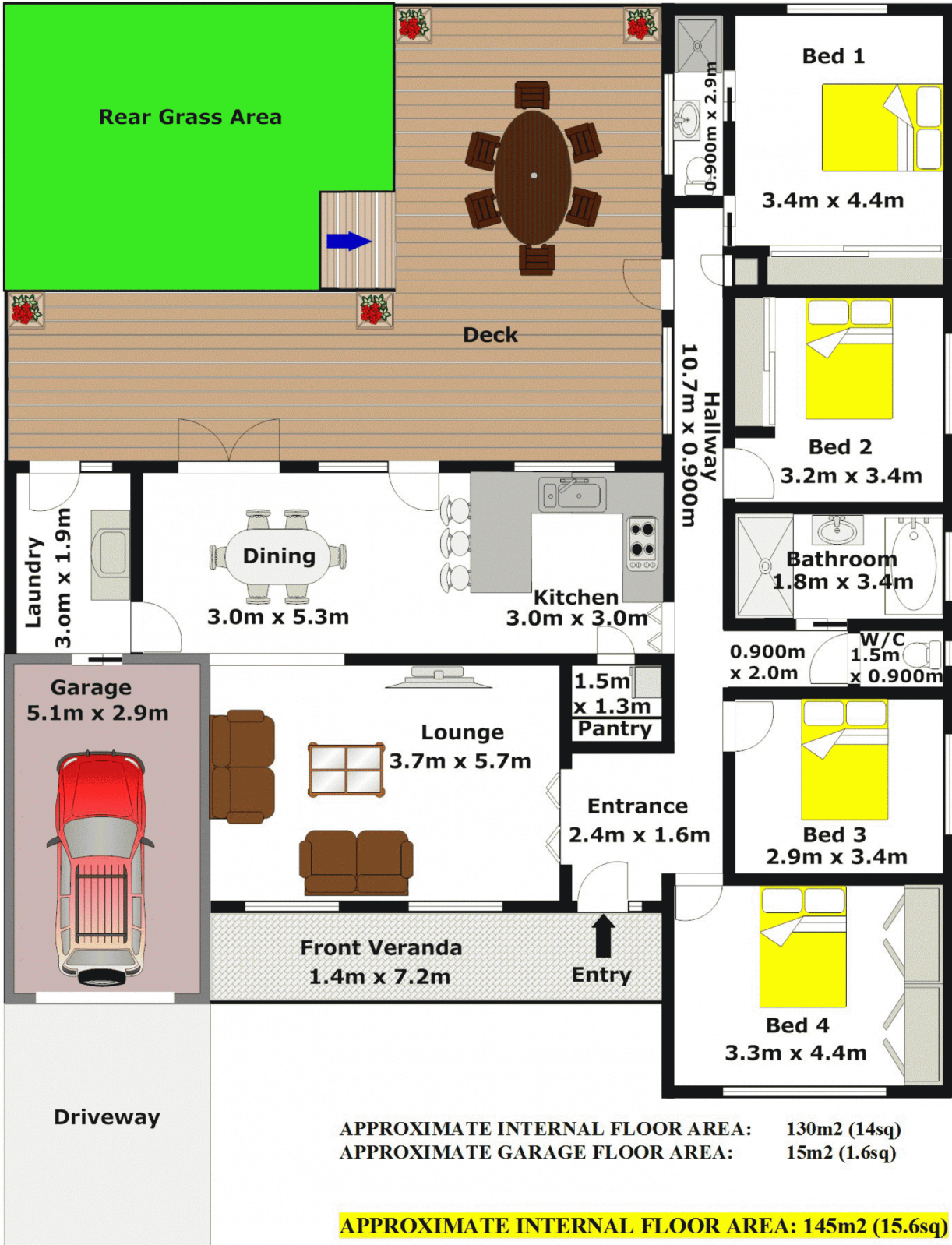

DISCLAIMER:

Whilst every attempt has been made to ensure the accuracy of the floor plan contained here, no responsibility is taken for any error, omission, or misstatement. This floor plan is intended as a guide only, for representation purposes only, and should be used as such by any prospective purchaser. No guarantee or warranties can be given, and any person using this information should rely on their own enquires.

