



CASTLE HILL

3 1 2

This family home is all about location, location, location! Situated on a 708sqm with a high side position in a quiet cul-de-sac. Immaculate inside & out and offering three bedrooms and an updated bathroom plus additional separate toilet. Spacious living for all the family includes formal lounge & dining, separate hobby room downstairs and updated kitchen with gas cooking. Fully landscaped front & rear yards plus decked above ground pool for cooling off in the summer. Enormous 2 to 4 car garage with internal access, 2000L water tank and split air-conditioning system. Close and convenient to all amenities, with only minutes to Castle Towers, transport, library and schools. SOLD 3rd June, 2011

Type : House
Land Size : 708 sqm
View : <https://www.gilmour.com.au/sale/nsw/hills/castle-hill/residential/house/5620005>



Gilmour Property Agents
02 9899 3311

Upper Level

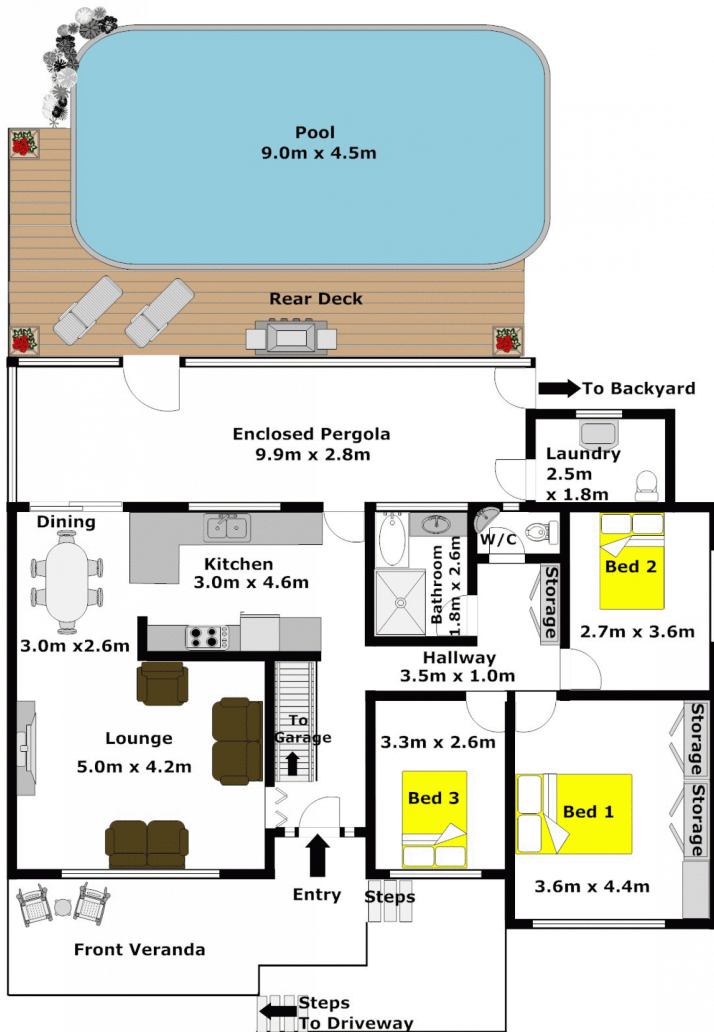

Lower Level

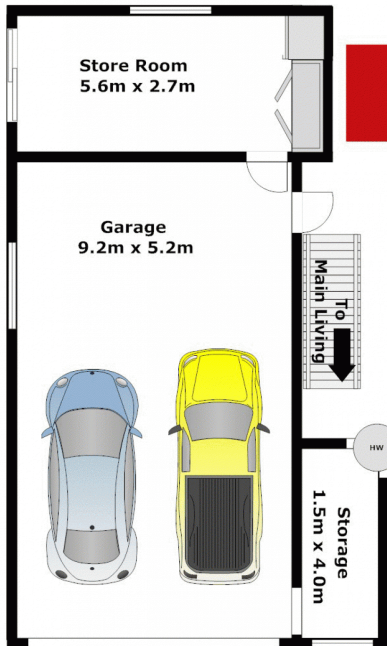

Gilmour
PROPERTY AGENTS

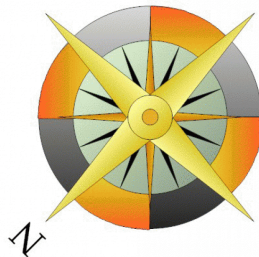

APPROXIMATE UPPER LEVEL FLOOR AREA: 122.54m² (13.1sq)
APPROXIMATE LOWER LEVEL FLOOR AREA: 68.96m² (7.4sq)

APPROXIMATE INTERNAL FLOOR AREA: 191.15m² (21sq)

DISCLAIMER:

Whilst every attempt has been made to ensure the accuracy of the floor plan contained here, no responsibility is taken for any error, omission, or misstatement. This floor plan is intended as a guide only, for representation purposes only, and should be used as such by any prospective purchaser. No guarantee or warranties can be given, and any person using this information should rely on their own enquiries.