



CHERRYBROOK

4  2  2 

The Manor Located in this exclusive secure estate sits an executive two storey, free standing family home on a private, manicured 573sqm block. Offering four generous bedrooms - all with built-in wardrobes and two bathrooms including ensuite in master. The home faces north with loads of natural light and 9 foot ceilings compliments the spacious living areas. Formal lounge & dining, separate TV/relaxing area & meals/family space adjoining the modern granite gas kitchen. Lovely grassed rear yard is overlooked by the kitchen-ideal for keeping an eye on the children playing. With 3 toilets, ducted air-conditioning, double automatic lock-up garage with internal access, alarm system and pets are allowed in the complex. Enjoy full use of the Manor House facilities including club house, pool, tennis court, billiard room, spa & sauna. Situated

Type : House
Land Size : 573 sqm
View : <https://www.gilmour.com.au/sale/nsw/hills/c/herrybrook/residential/house/5619999>



Gilmour Property Agents
02 9899 3311

[For full version visit the website](https://www.gilmour.com.au)

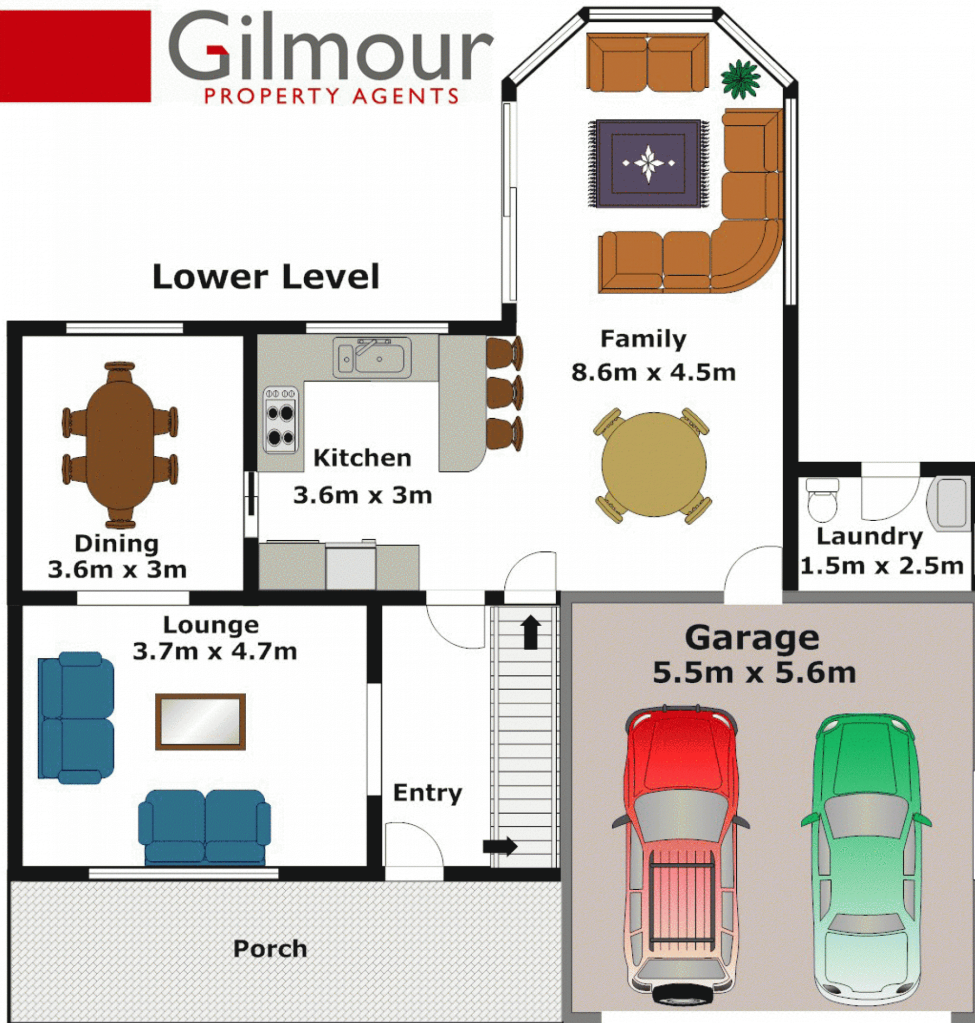

Upper Level

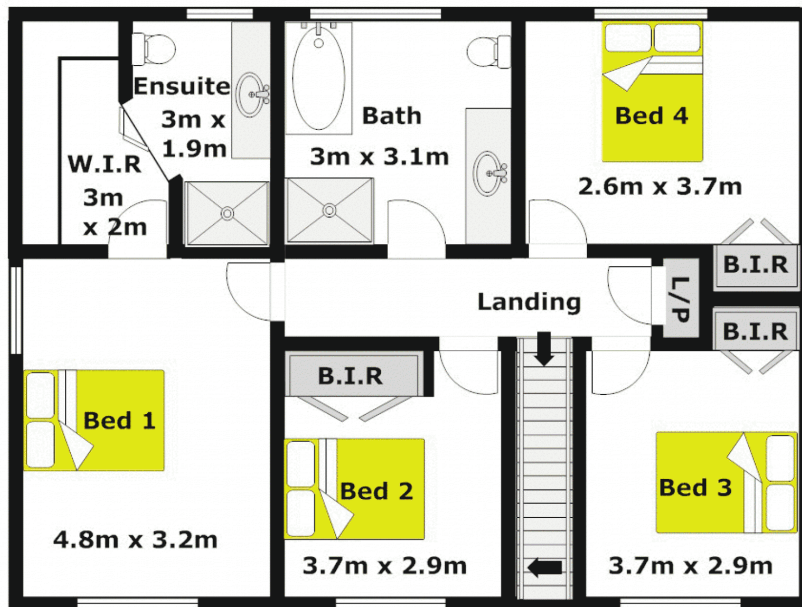

APPROXIMATE UPPER LEVEL FLOOR AREA: 84m² (9sq)
 APPROXIMATE LOWER LEVEL FLOOR AREA: 94m² (10sq)
 APPROXIMATE GARAGE FLOOR AREA: 31m² (3sq)

APPROXIMATE INTERNAL FLOOR AREA: 209m² (22sq)

DISCLAIMER:

Whilst every attempt has been made to ensure the accuracy of the floor plan contained here, no responsibility is taken for any error, omission, or misstatement. This floor plan is intended as a guide only, for representation purposes only, and should be used as such by any prospective purchaser. No guarantee or warranties can be given, and any person using this information should rely on their own enquires.

