



GLENHAVEN

4  2  2 

Single level family home on a 900sqm block set in a whisper quiet cul-de-sac that is one of Glenhaven's best. Offering four bedrooms, three with built-in wardrobes and walk-in robe plus ensuite in the master bedroom. Generous living areas include rumpus, high vaulted ceilings in the sunken formal lounge & dining room and meals area that is adjacent to the functional kitchen with breakfast bar. Lovely grassed front & rear yard for the kids to run around, paved outdoor entertaining area and in-ground pool with water feature. Ducted air-conditioning and double lock-up garage with internal access complete the package. Conveniently located to shops, schools and transport-a must see home!
SOLD 29TH March, 2011

Type : House
Land Size : 900 sqm
View : <https://www.gilmour.com.au/sale/nsw/hills/glenhaven/residential/house/5619987>



Gilmour Property Agents
02 9899 3311

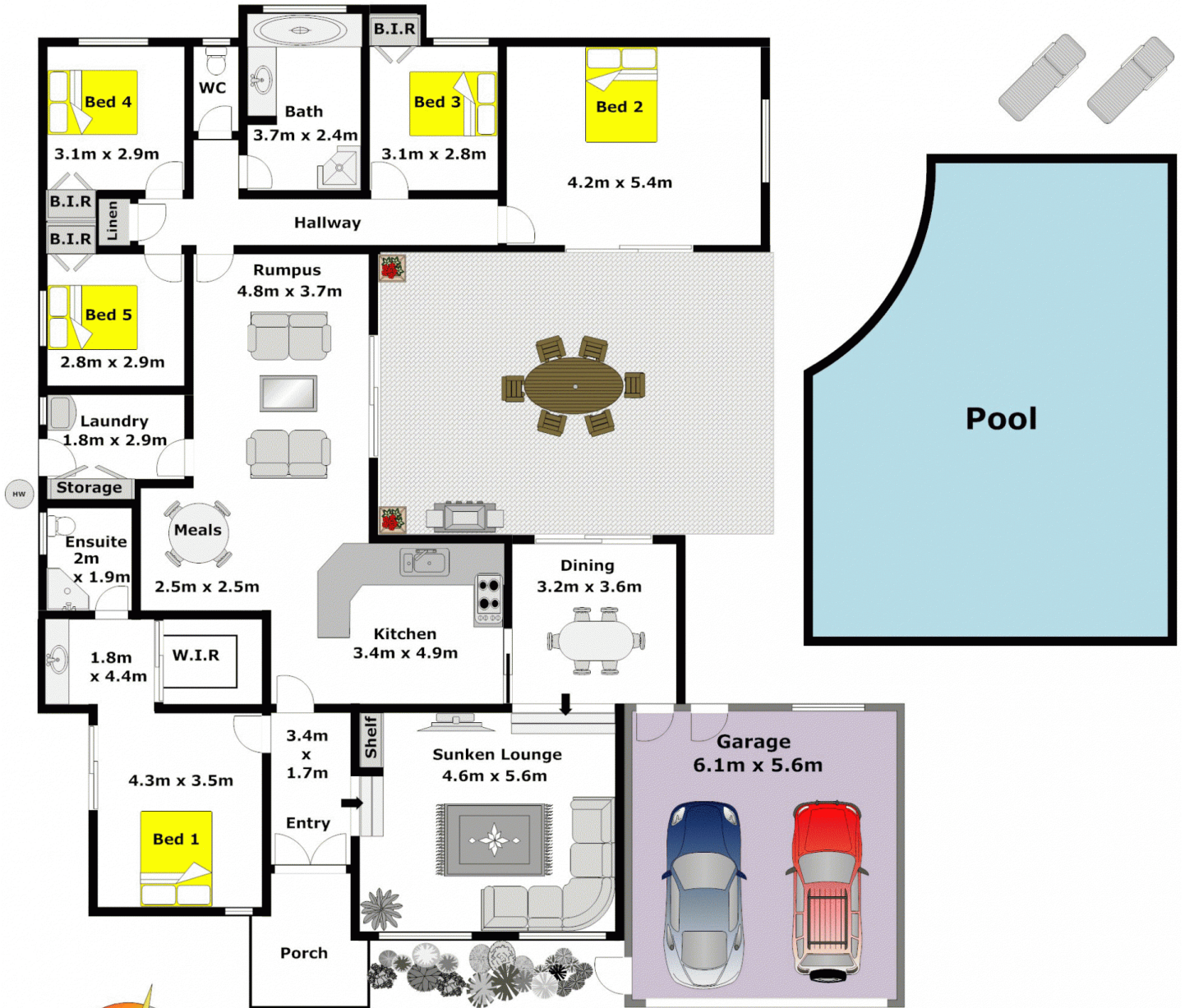

APPROXIMATE INTERNAL FLOOR AREA: 214m² (23sq)
 APPROXIMATE GARAGE FLOOR AREA: 34m² (4sq)

APPROXIMATE TOTAL FLOOR AREA: 248m² (27sq)

DISCLAIMER:

Whilst every attempt has been made to ensure the accuracy of the floor plan contained here, no responsibility is taken for any error, omission, or misstatement. This floor plan is intended as a guide only, for representation purposes only, and should be used as such by any prospective purchaser. No guarantee or warranties can be given, and any person using this information should rely on their own enquires.

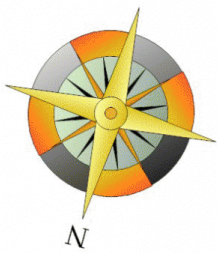

N

Gilmour
 PROPERTY AGENTS